

### Important Information:

Before you begin assembly, please read these directions. After product is assembled make sure all bolts and screws are securely tightened.

If a part is missing or broken or if you have any questions please call us right away for customer service. Your complete satisfaction with this product is important to us. **Call 1-800-BABYAGE (222-9243)**

Thank you for purchasing this Today's Tot product. At BabyAge.com, our goal is to provide every customer with an exceptional online shopping experience. We take our customers' concerns seriously, and encourage open communication before, during, and after a purchase is made. We strive to create a Today's Tot product that will be of lasting value to both you and your child. This product was constructed with high quality materials and is held to the highest safety standards.

Understanding that occasionally circumstances may result in a less-than-perfect product, we will make every possible effort to correct the situation.

If you have any type of question or comment regarding your Today's Tot product, I would encourage you to contact us via our web site contact form (<http://www.babyage.com/customersupport.aspx>) or our Toll-Free Customer Service number. 1-800-BABYAGE (222-9243)

Your complete satisfaction is of the utmost importance to us, and we thank you for the privilege of helping you care for your child.

Best,



Jack Kiefer (President & CEO)

today's•tot®

360 Stewart Road  
Wilkes-Barre, PA 18706  
[www.BabyAge.com](http://www.BabyAge.com)  
1-800-BabyAge

### Product Packaging Information

Model #: \_\_\_\_\_

Color: \_\_\_\_\_

Shipment Ref. #: \_\_\_\_\_

Packdate: \_\_\_\_\_

**MADE IN CHINA**

today's•tot®



## TODAYS TOT EMILY DOLLS HOUSE

### Important Information:

Before you begin assembly, please read these directions. See next page for important warning statements on this product. After product is assembled make sure all bolts and screws are securely tightened.

This item must be assembled by an adult. Special care must be taken when unpacking and assembling this item. Unassembled parts may be a choking hazard to children 3 years of age and under.



# WARNING



Please read these instructions before use of this product. Failure to follow these warnings and the assembly instructions could result in serious injury or death. Please save manual for future use as it contains important information.

- Read all instructions before use.
- Keep instructions for future use.
- FALL HAZARD—To prevent death or serious injury, always keep child within arm's reach.
- This product contains bolts and other small parts that may present a choking hazard for children 3 years or under. This unit must be assembled by an adult.
- Wash with mild soap and a damp cloth. Do not use abrasives. Avoid furniture polish that may be hazardous to a child. If refinishing, use a non-toxic finish specified for children's products.

## PART LIST

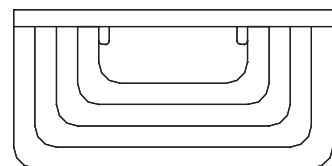

(A) Front Steps  
(1 pc)

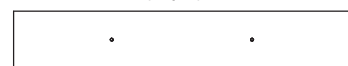

(B) Foundation Panel  
(1 pc)



(C) Foundation Panel  
(1 pc)



(D) Foundation Panel  
(1 pc)



(E) Foundation Panel  
(1 pc)



(F) Foundation Panel  
(1 pc)



(G) Foundation Panel  
(1 pc)



(H) Foundation Panel  
(1 pc)

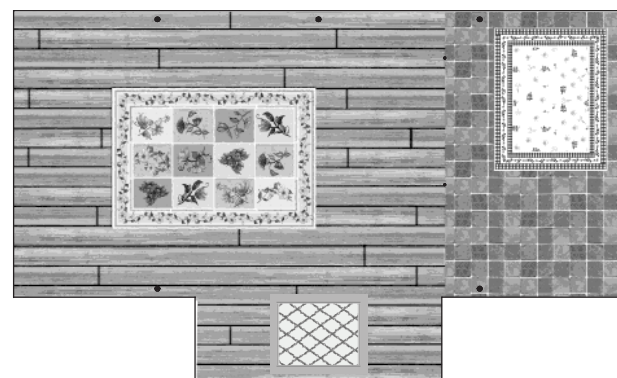

(I) Floor Panel  
(1 pc)

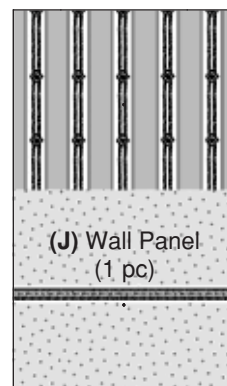

(J) Wall Panel  
(1 pc)

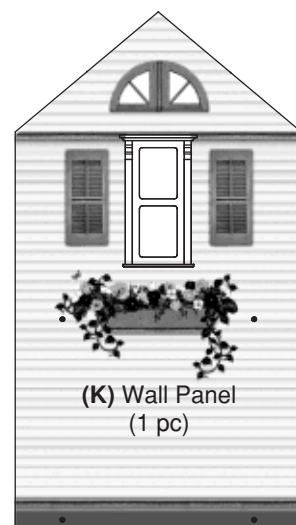

(K) Wall Panel  
(1 pc)



(L) Wall Panel  
(1 pc)



(M) Wall Panel  
(1 pc)



(N) Wall Panel  
(1 pc)



(O) Wall Panel  
(1 pc)



(P) Wall Panel  
(1 pc)



(Q) Wall Panel  
(1 pc)

## NOTES:



30

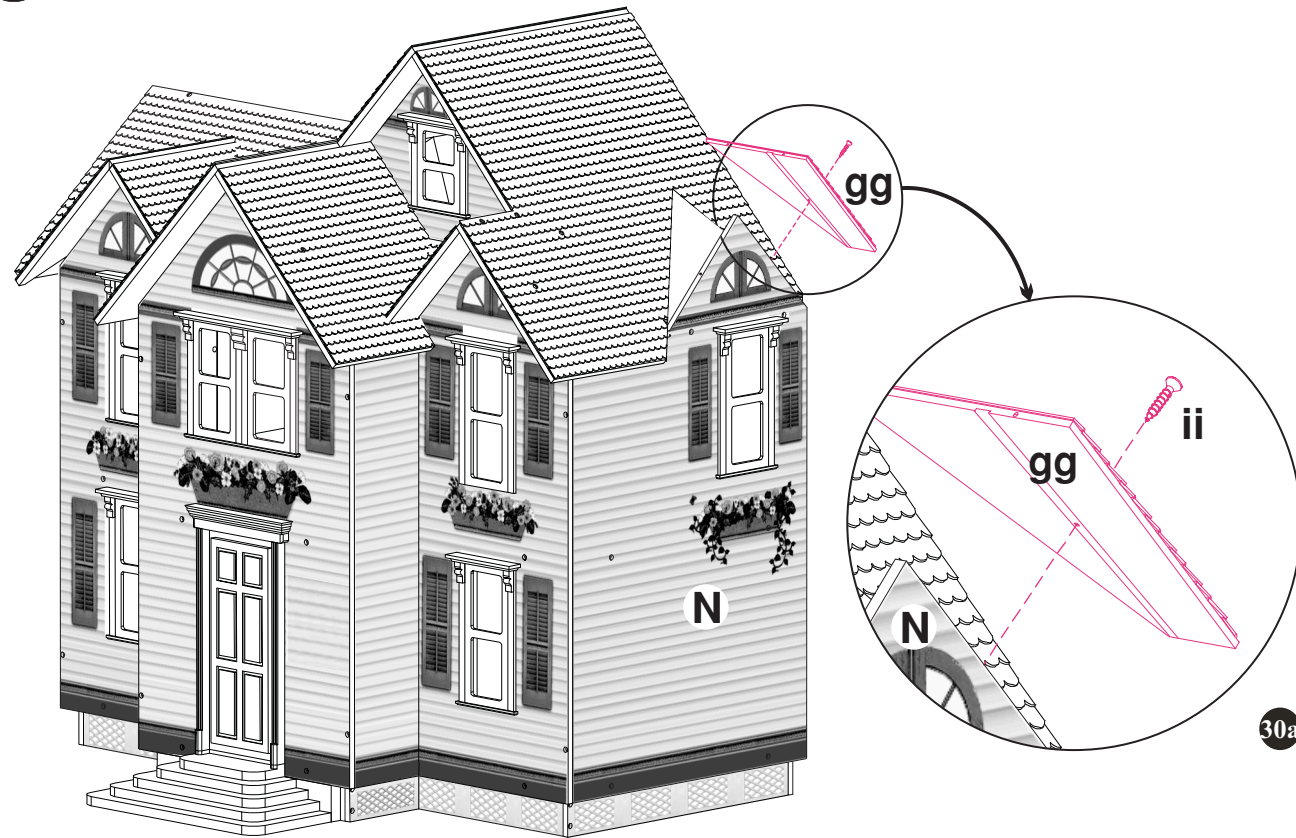

30a

31

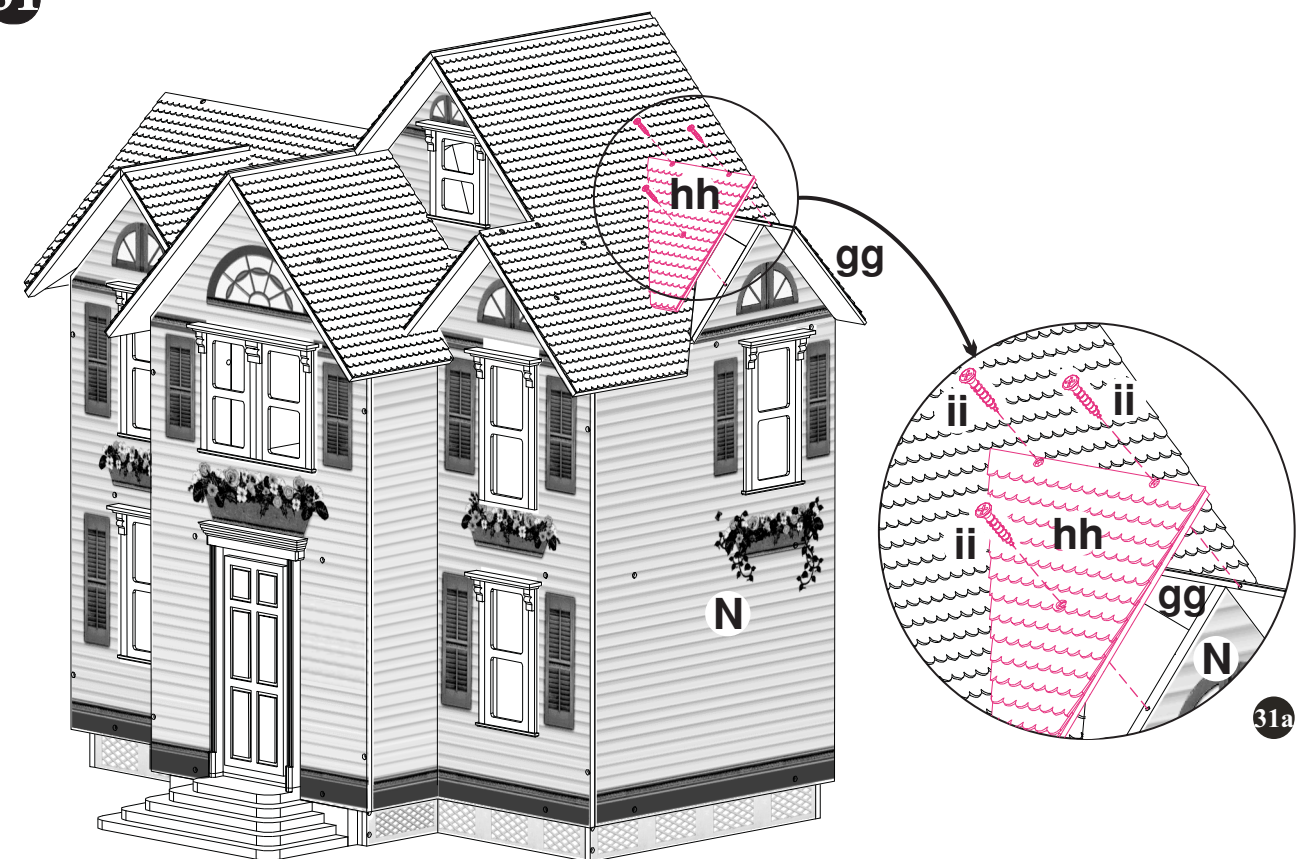

31a

# PART LIST

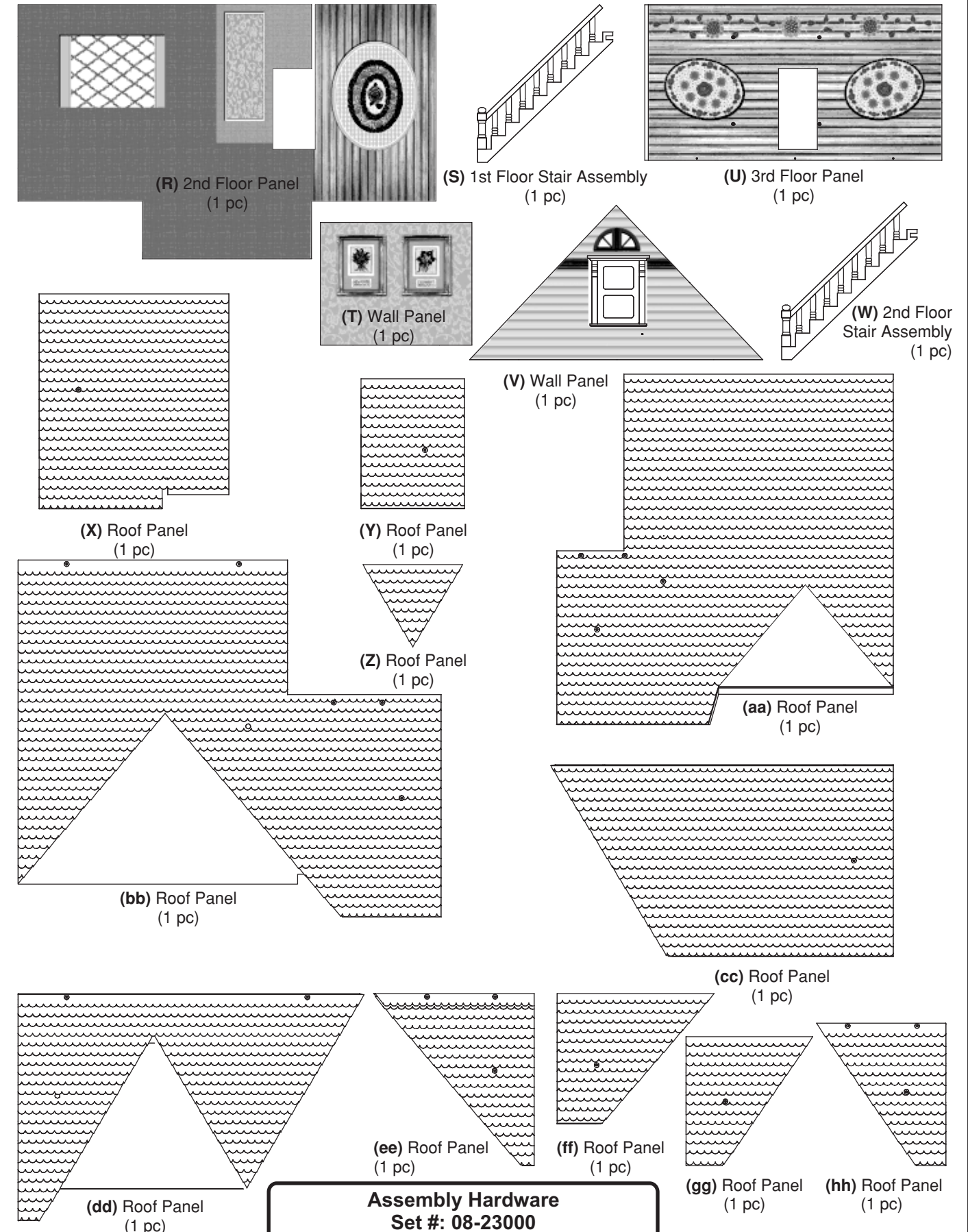

## Assembly Hardware Set #: 08-23000



(ii) 3 x 20mm Screw  
Part #07-01000  
(91 pcs + 2 pcs extra)



# ASSEMBLY STEPS

1

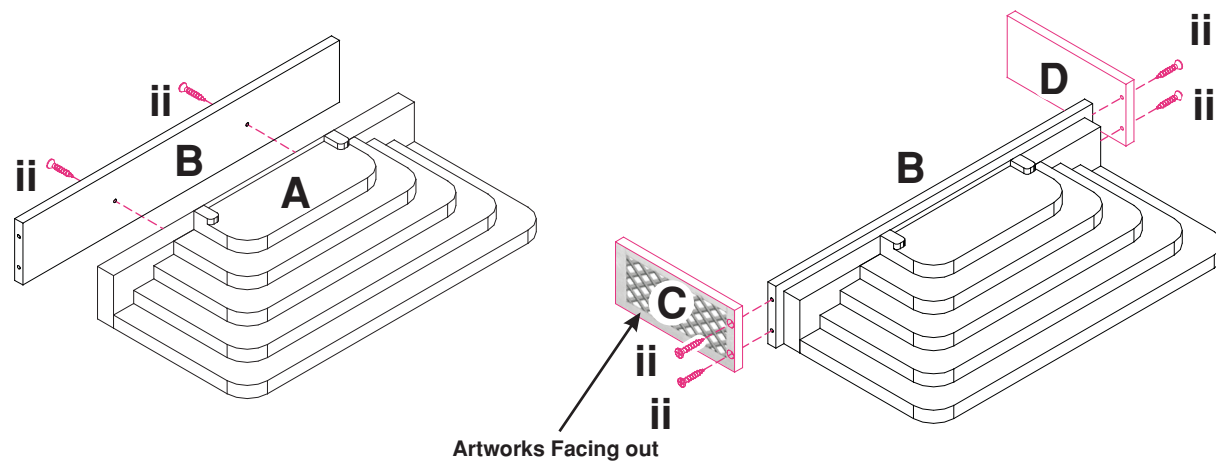

2

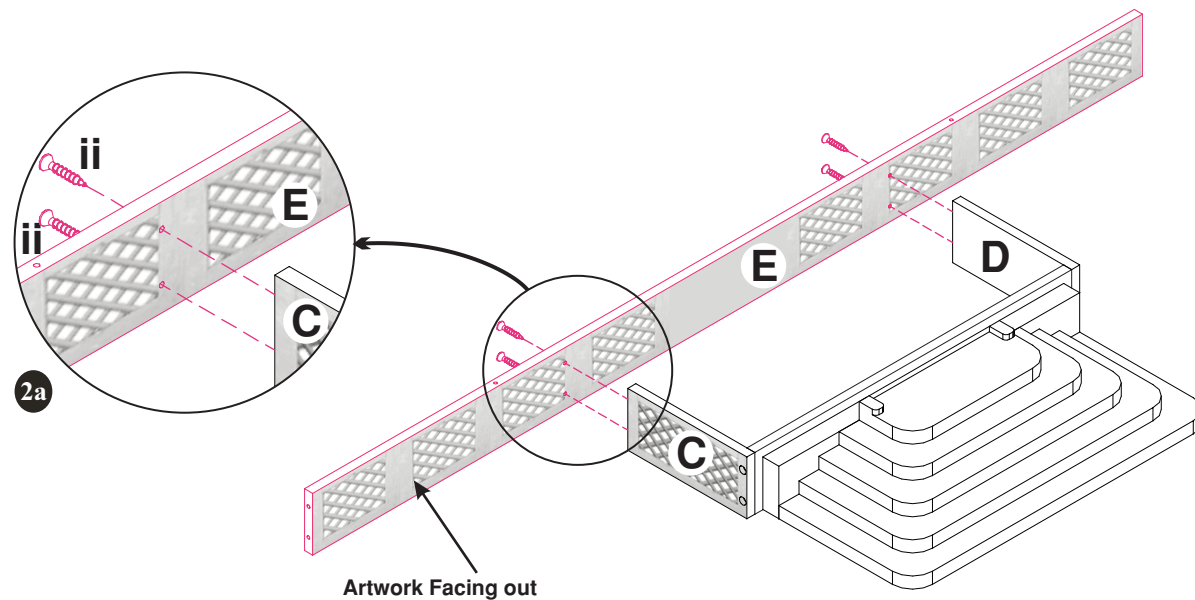

3

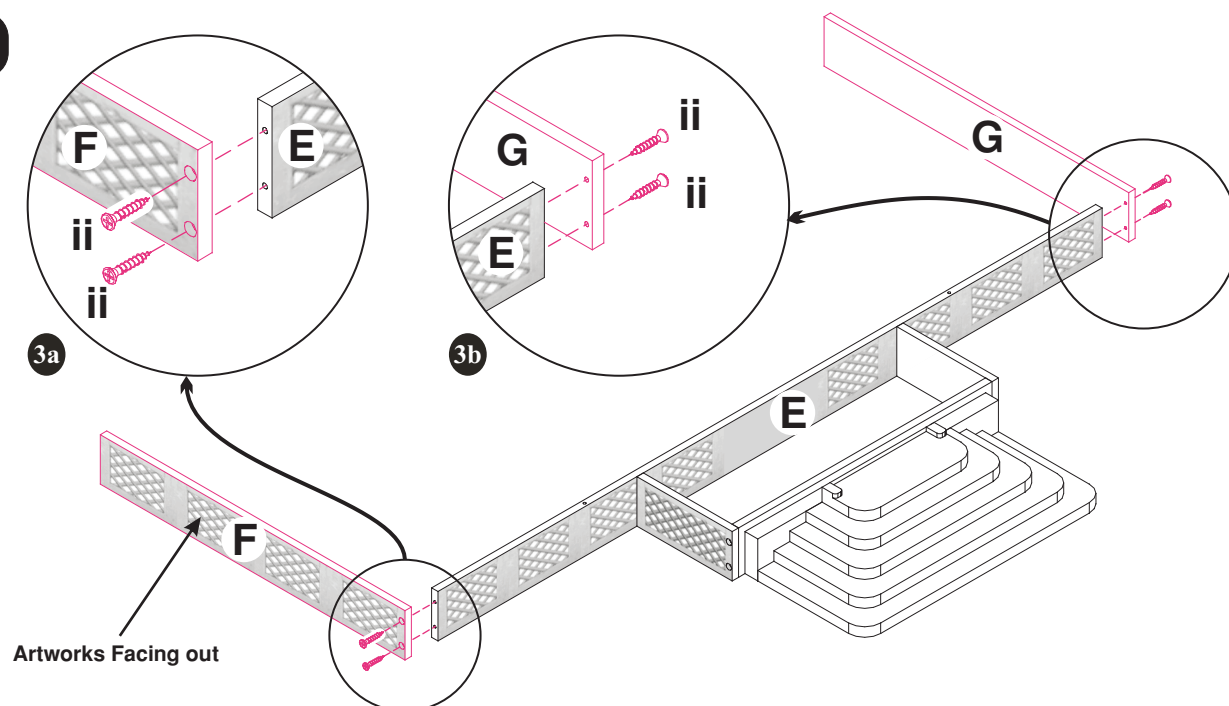

28

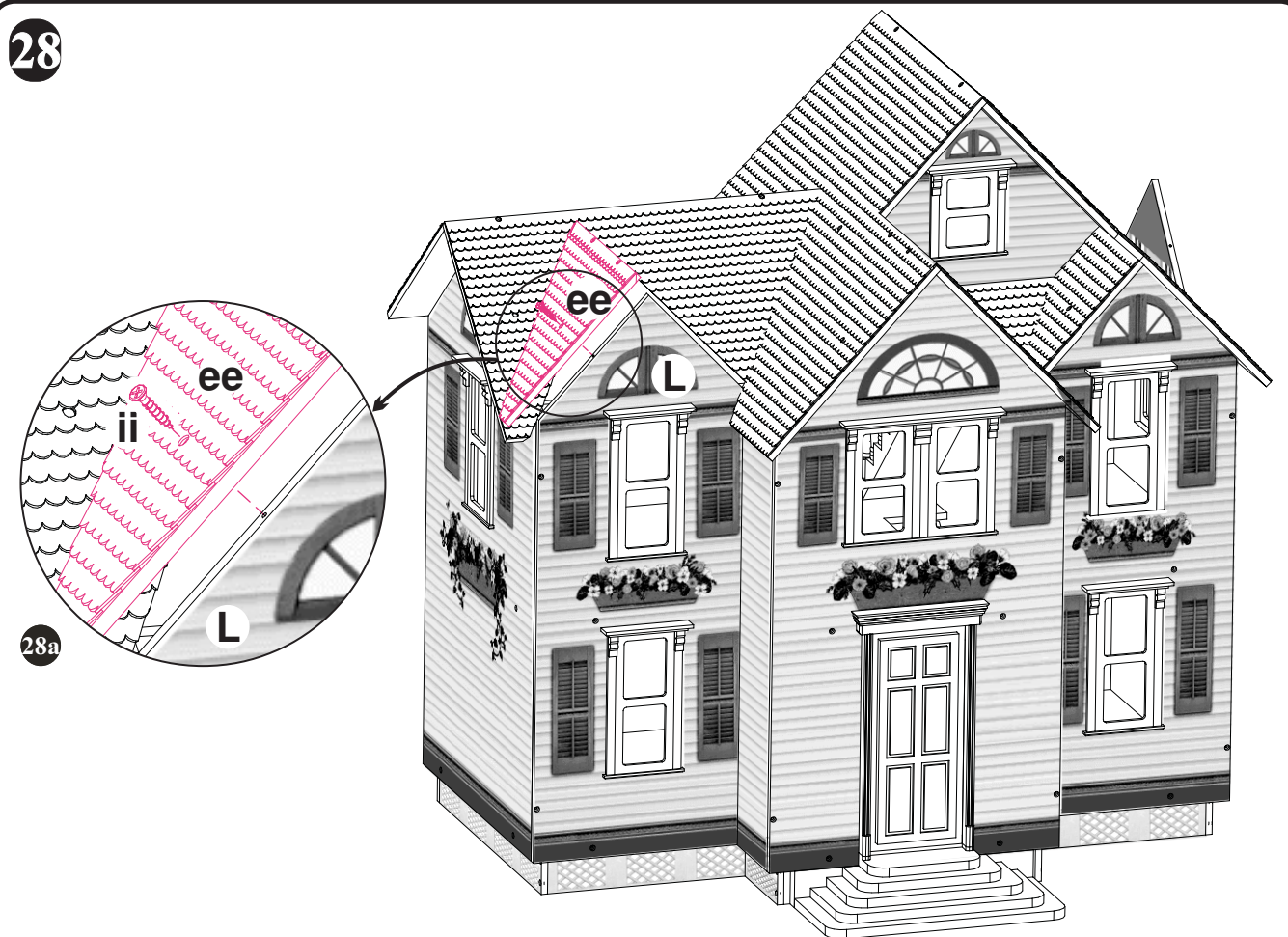

29

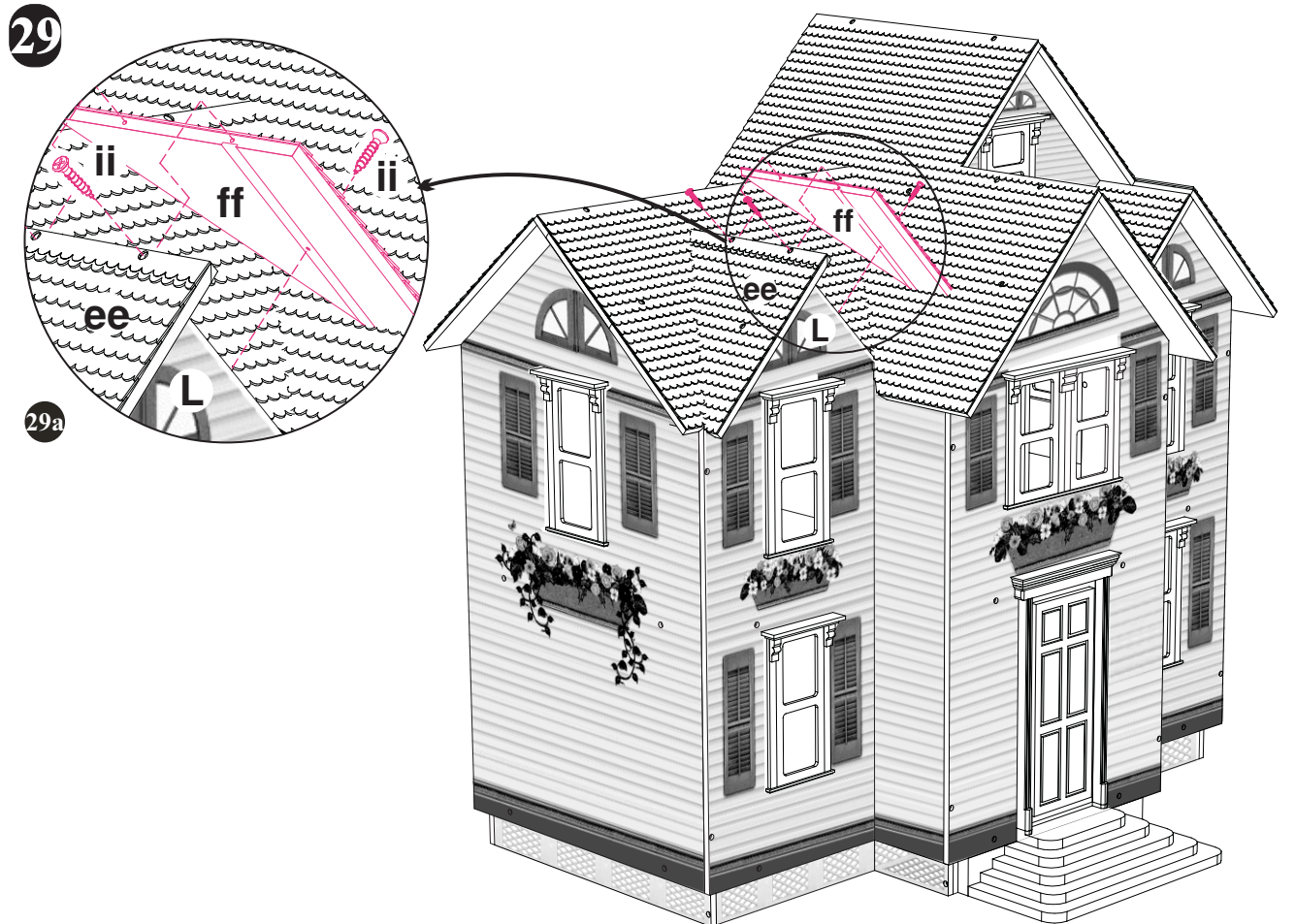



26

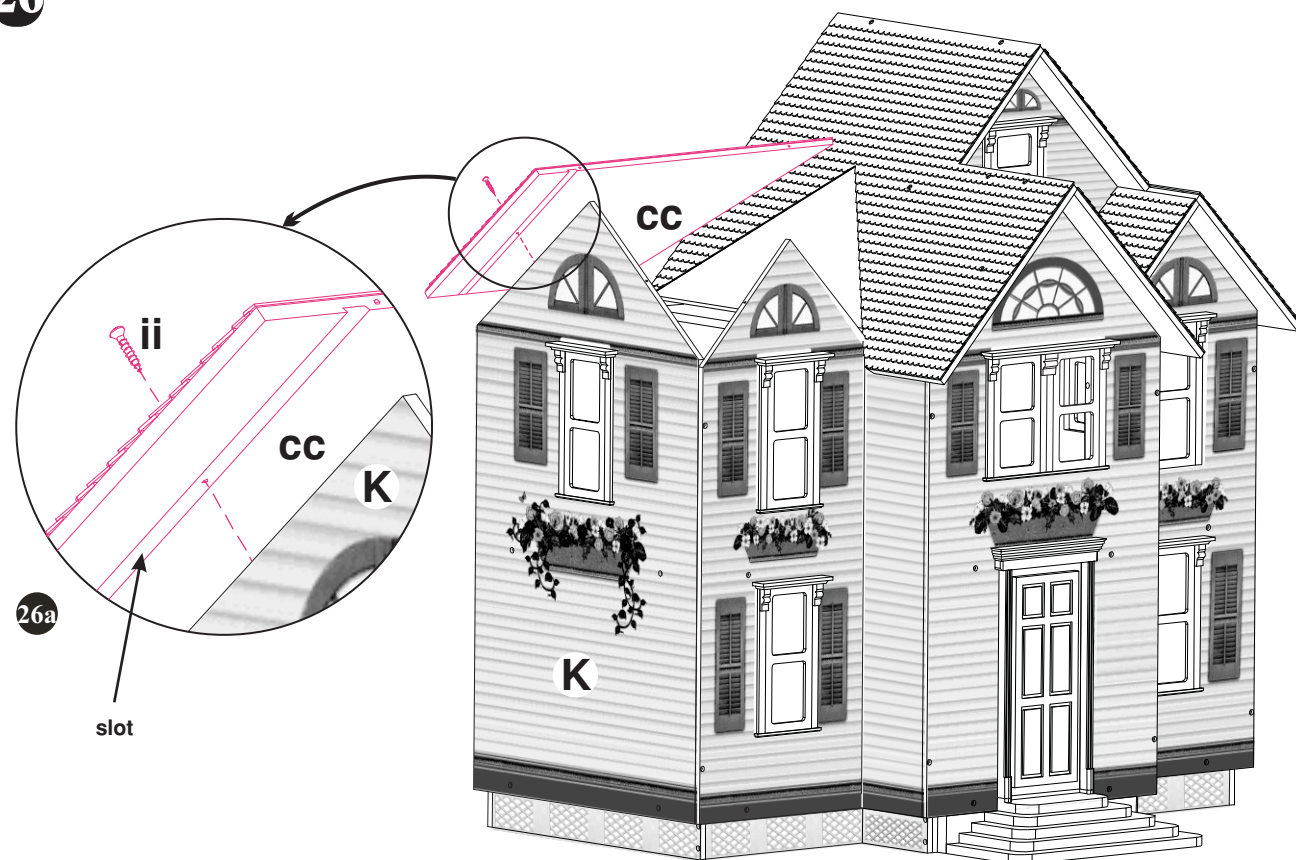

27

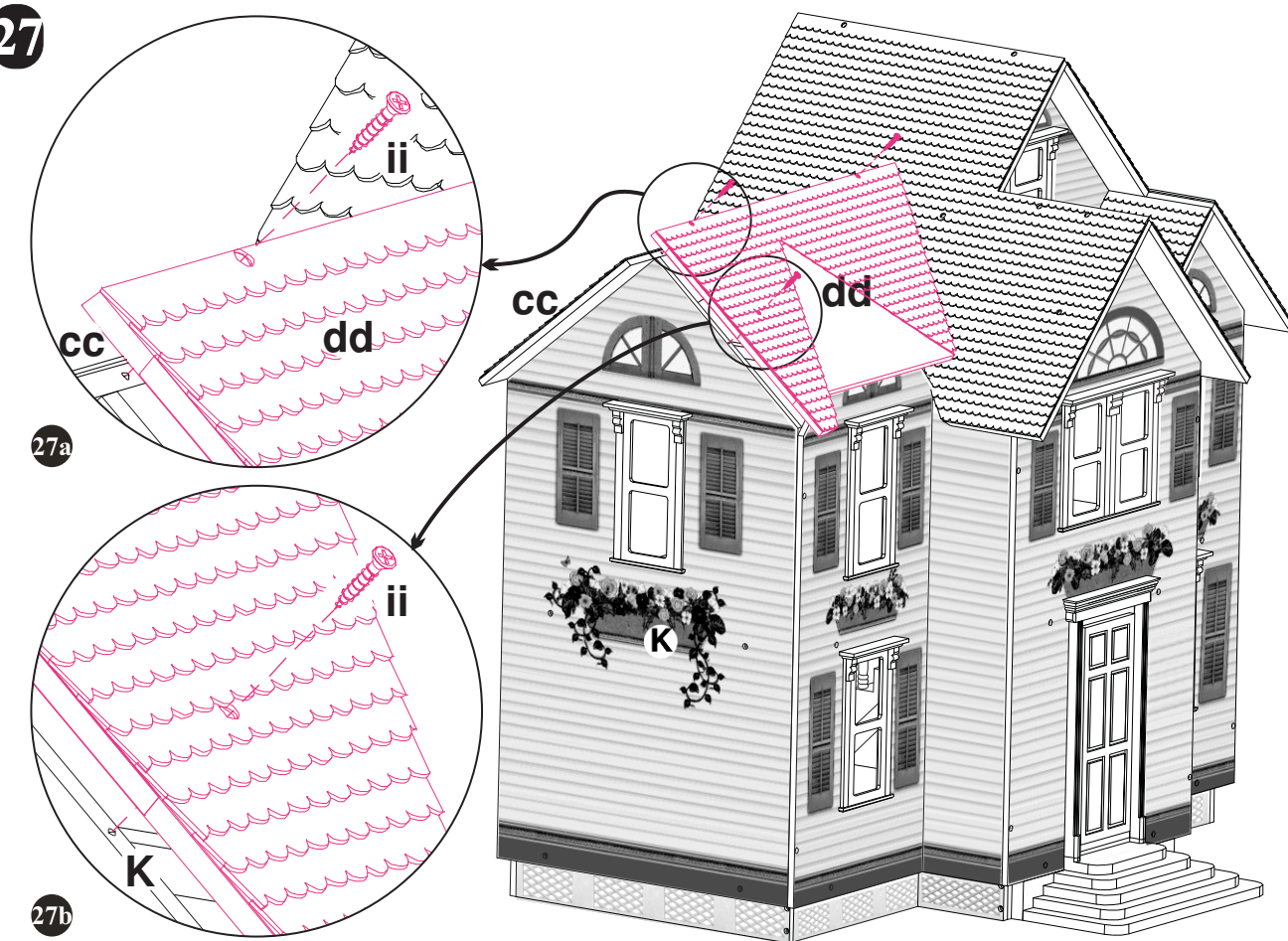

4

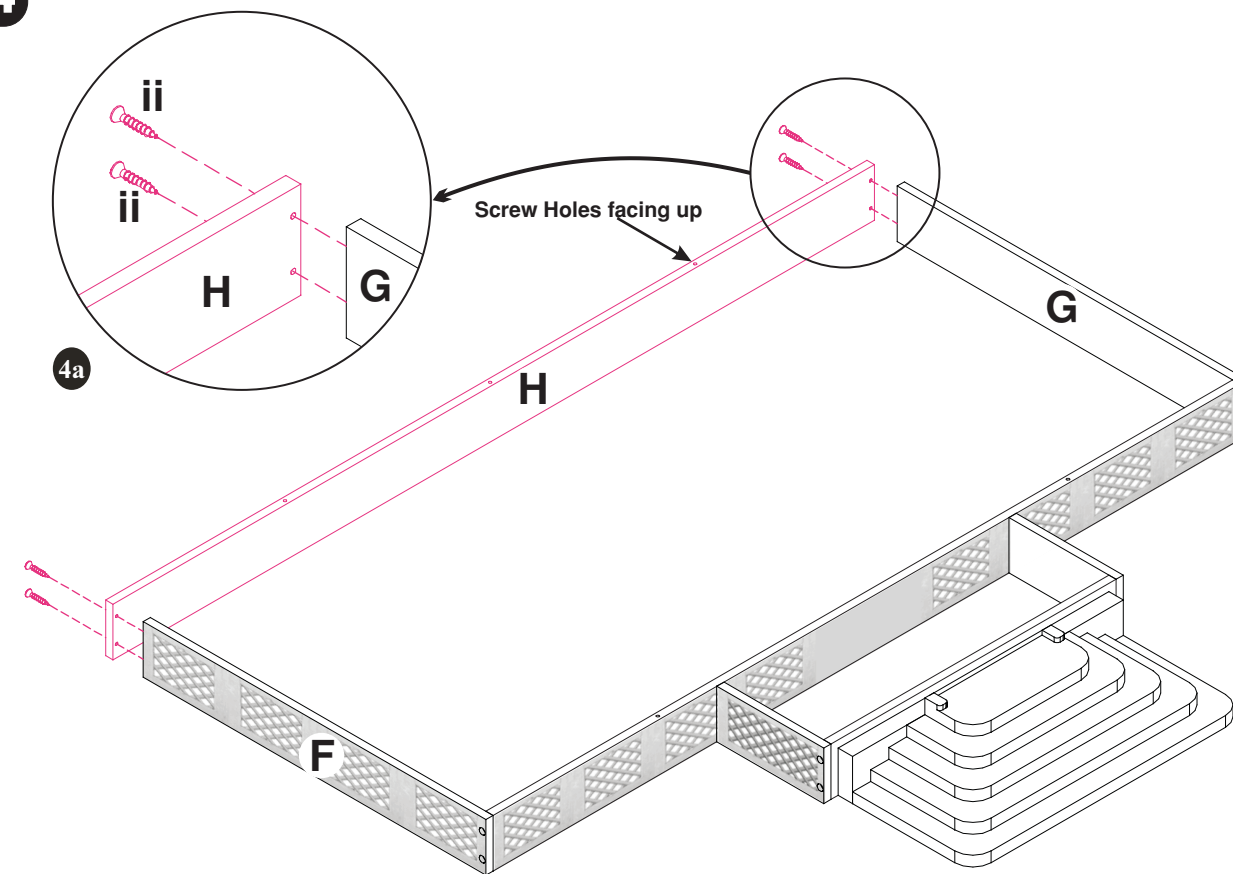

5

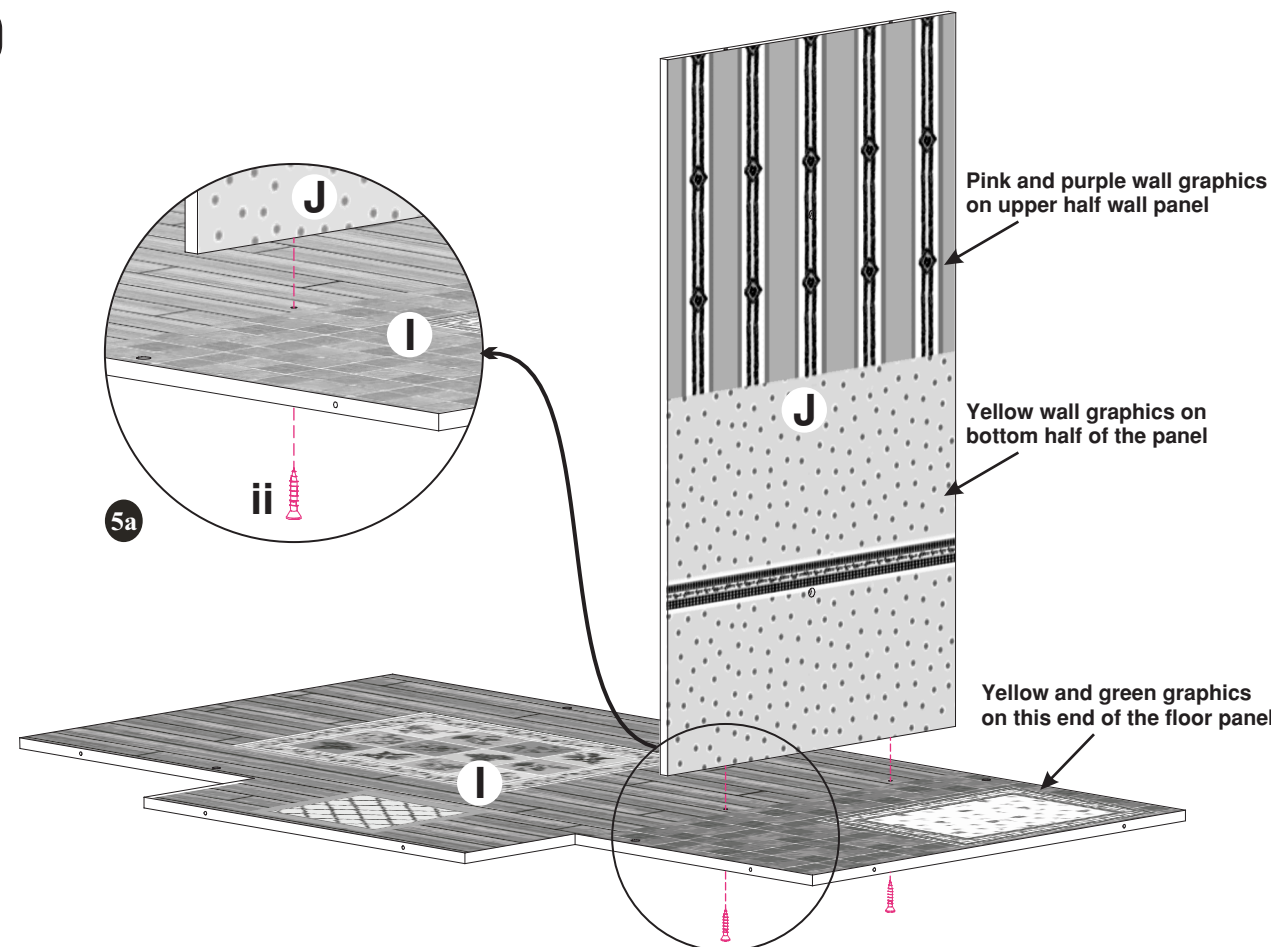



6

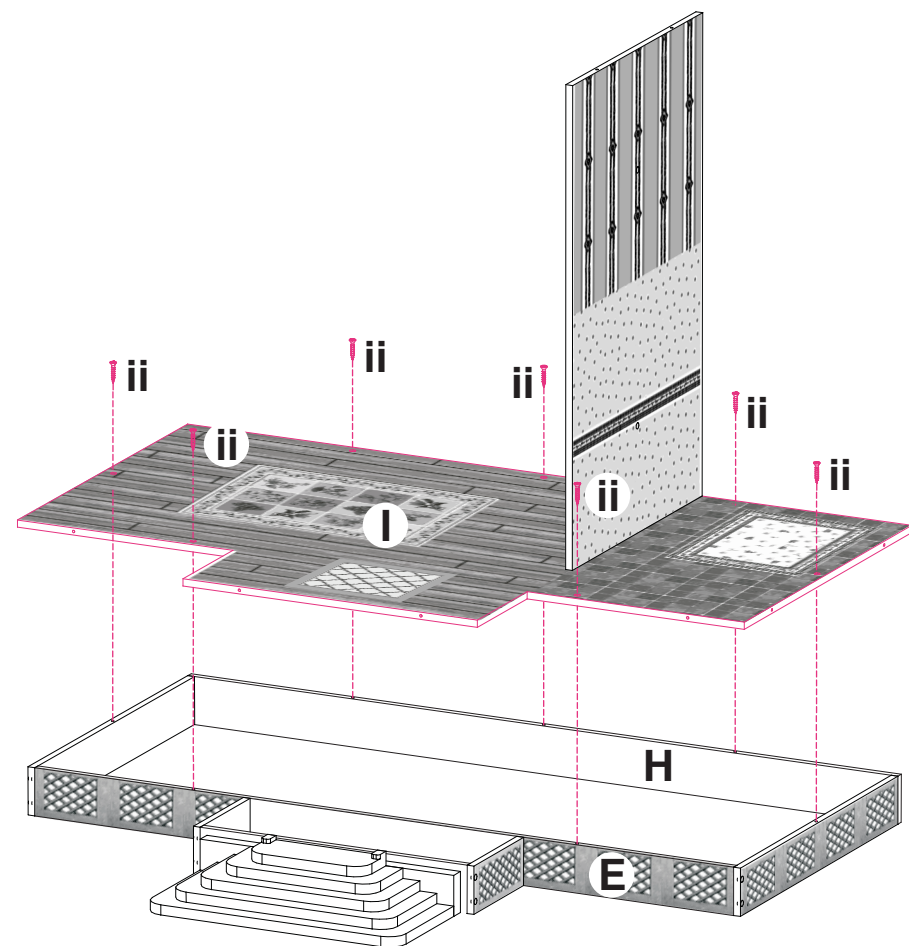

7

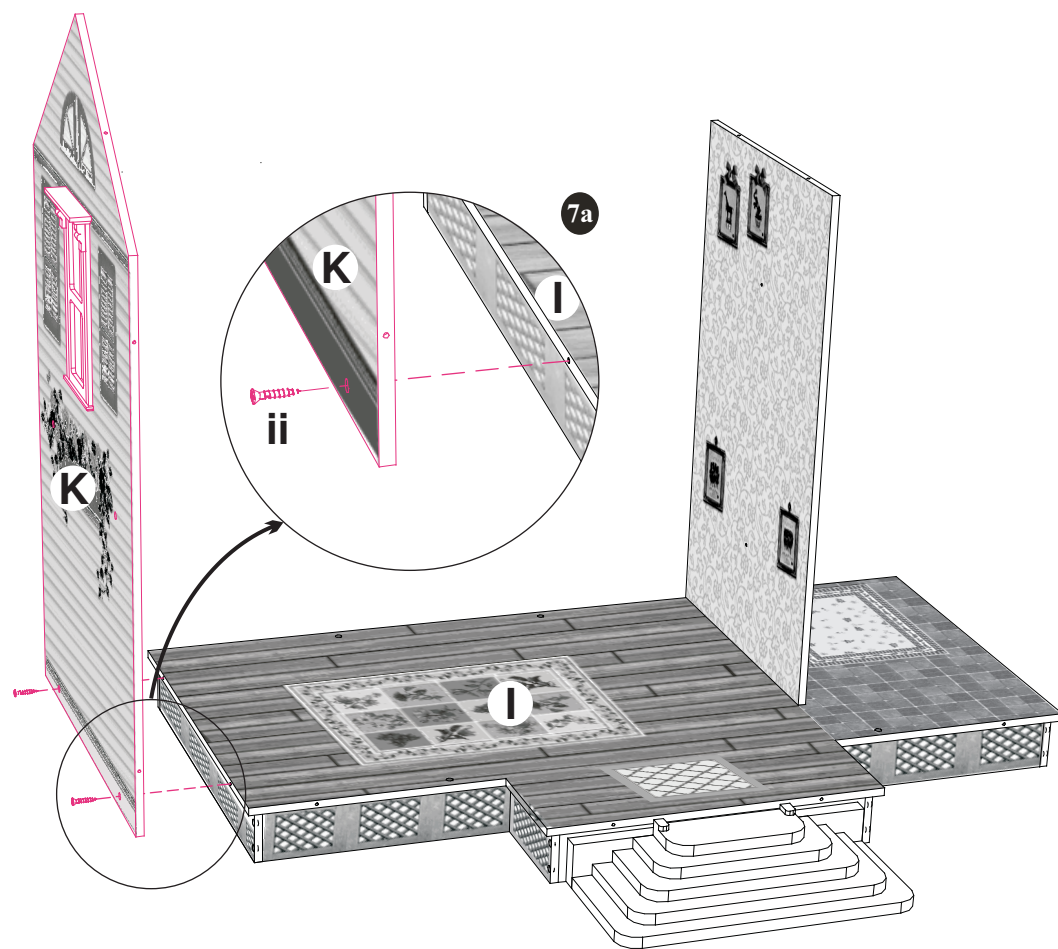

24

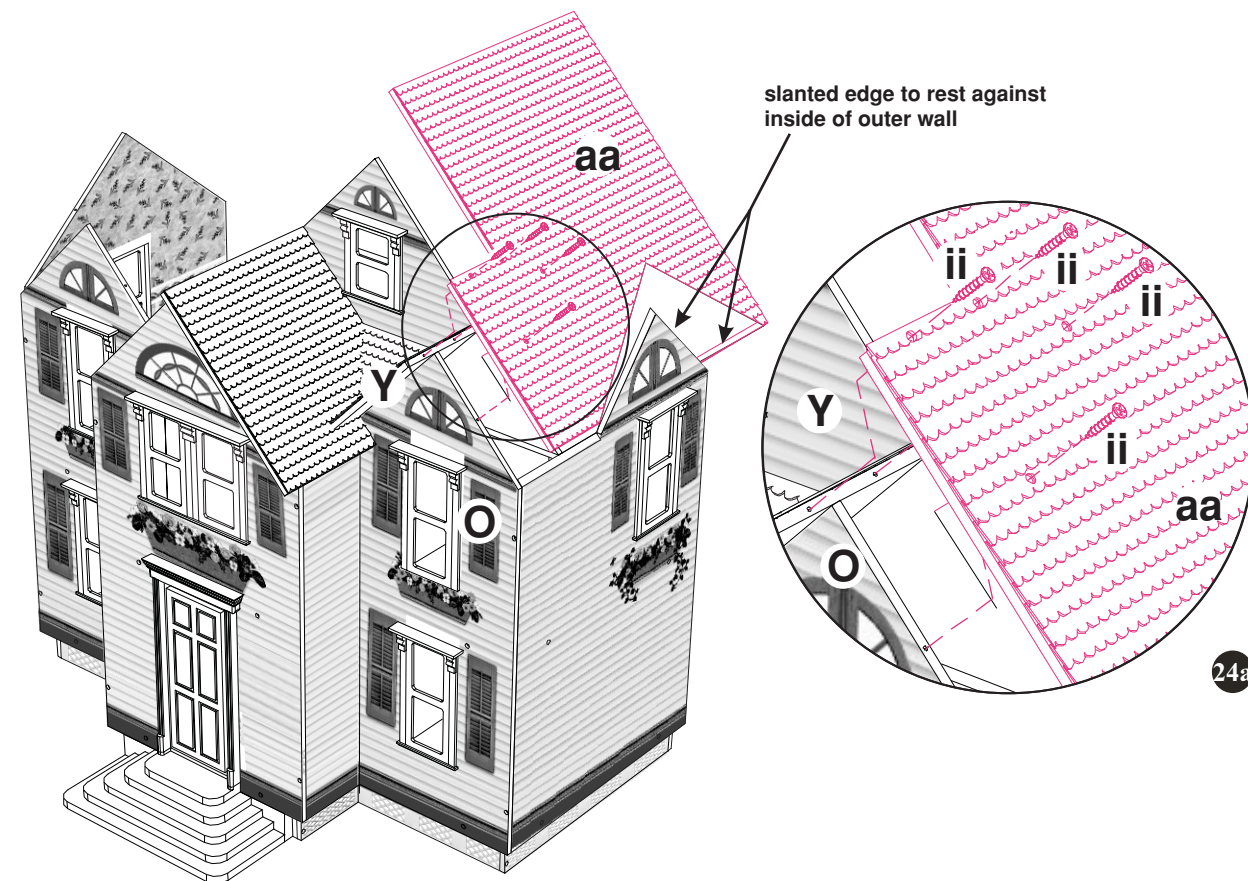

25

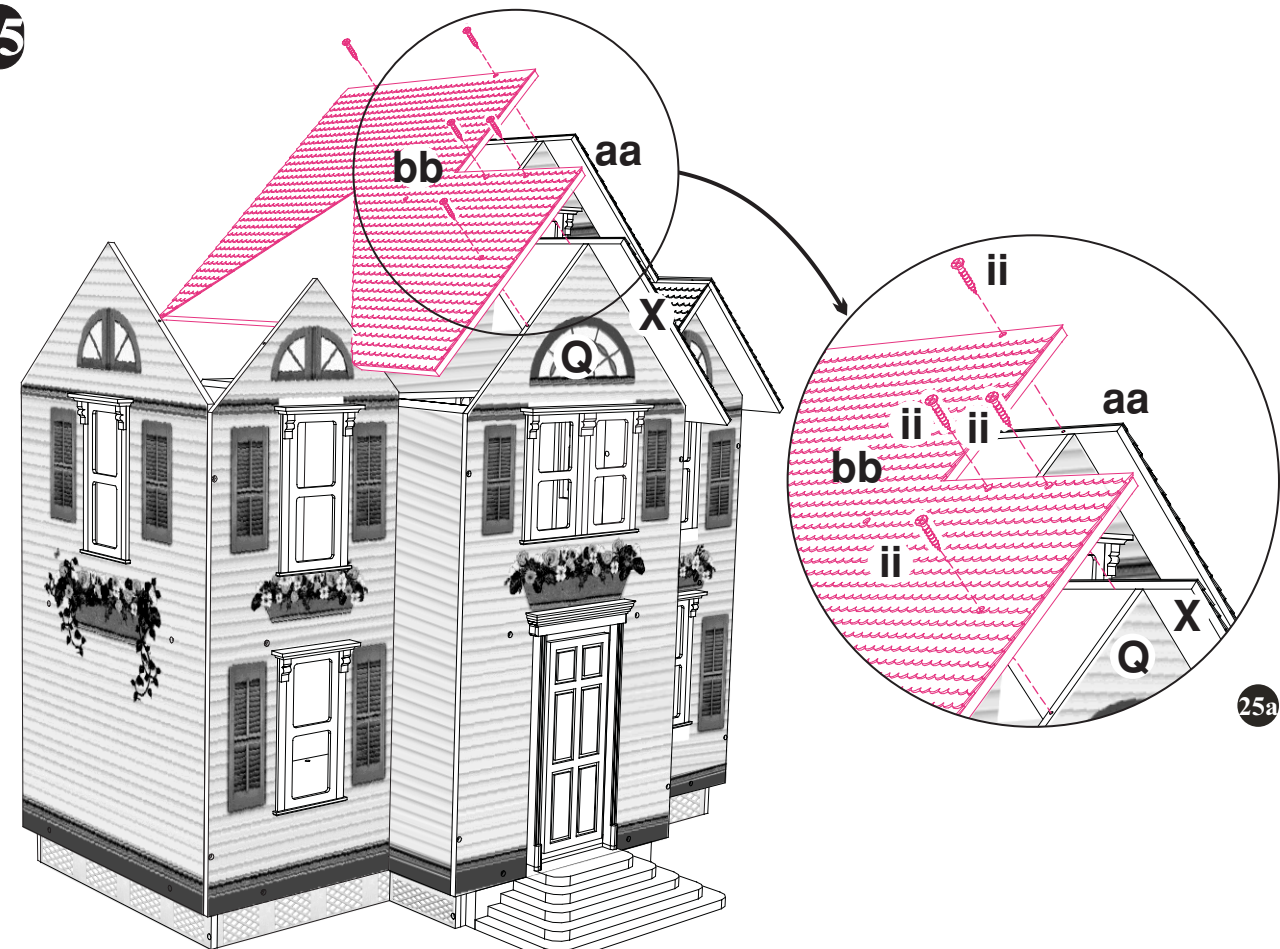



22

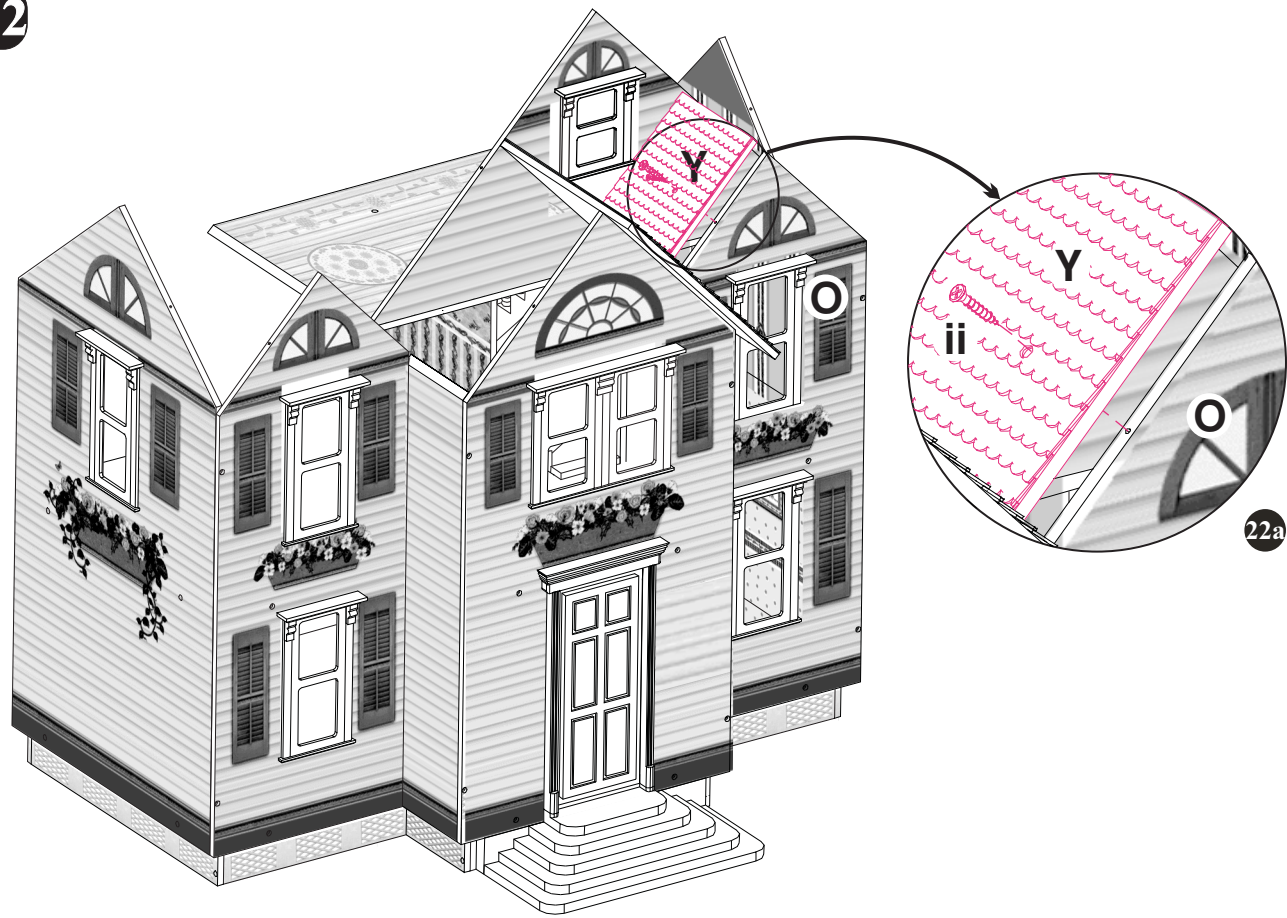

23

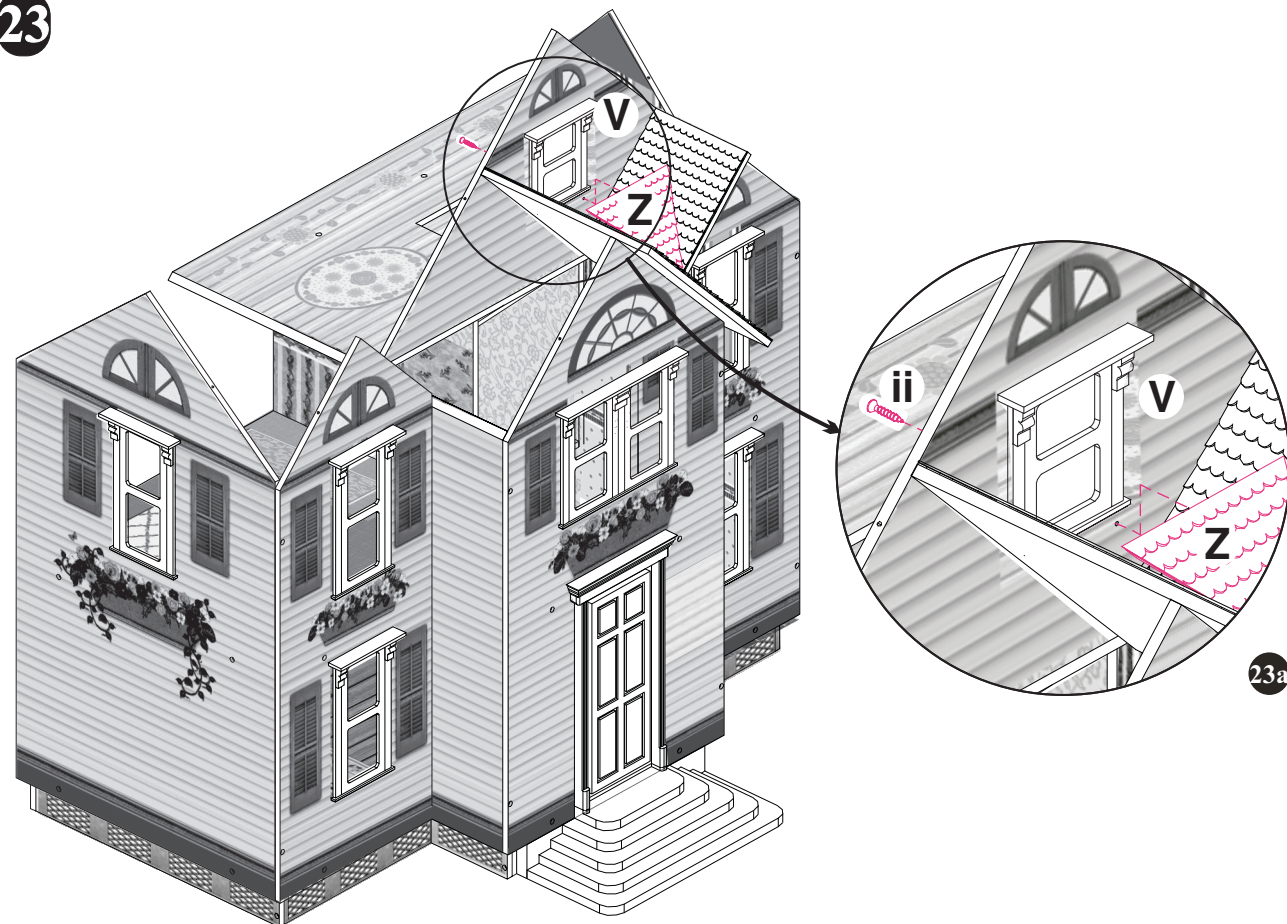

8

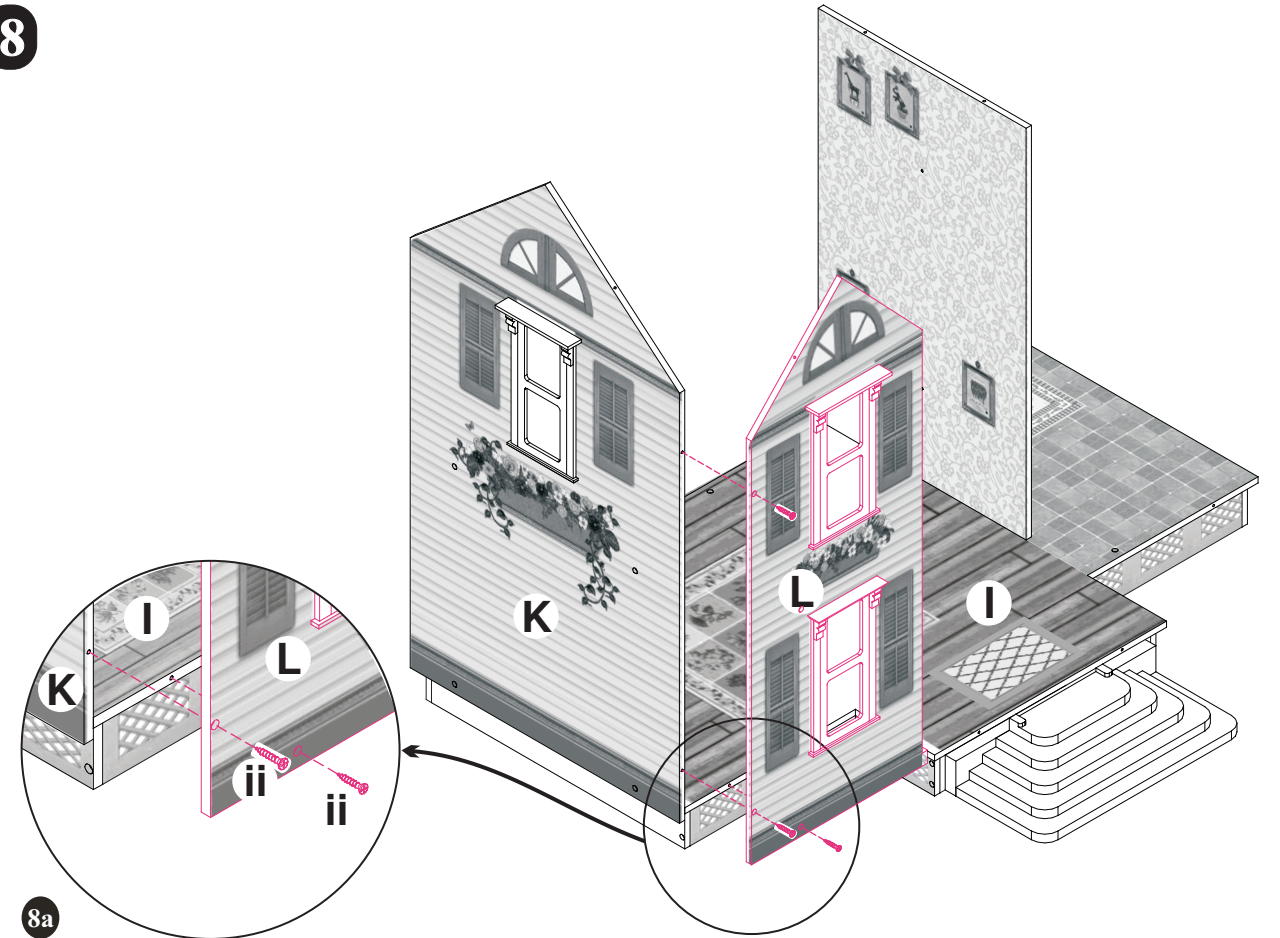

9

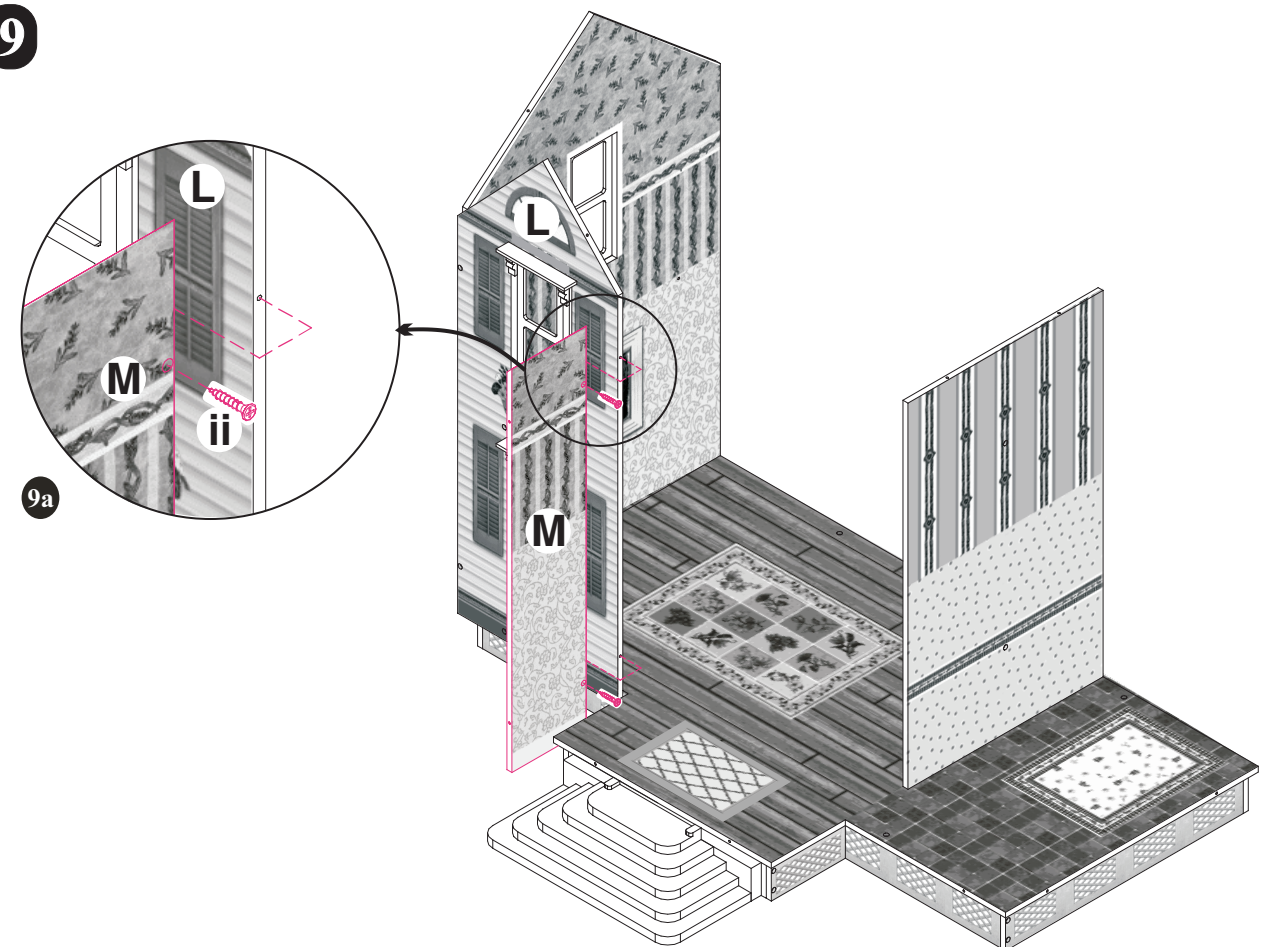



10

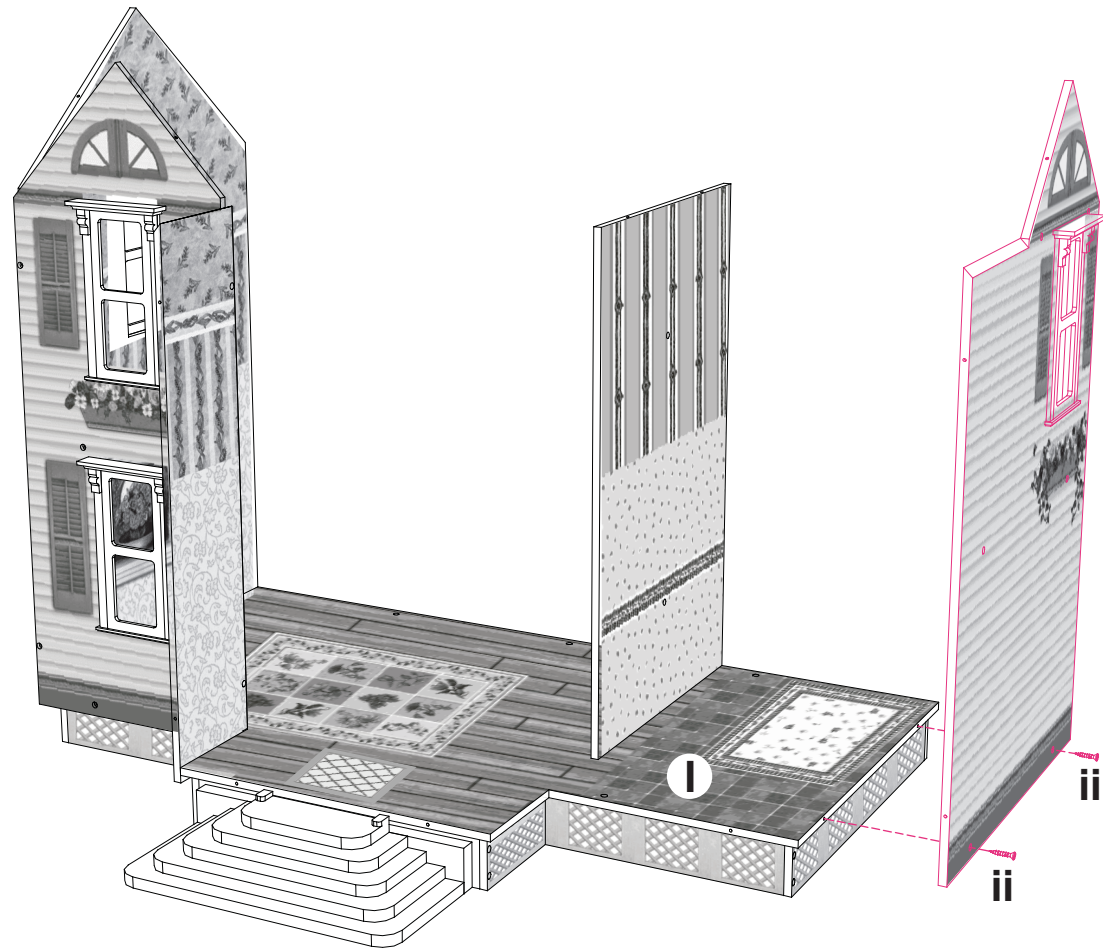

11

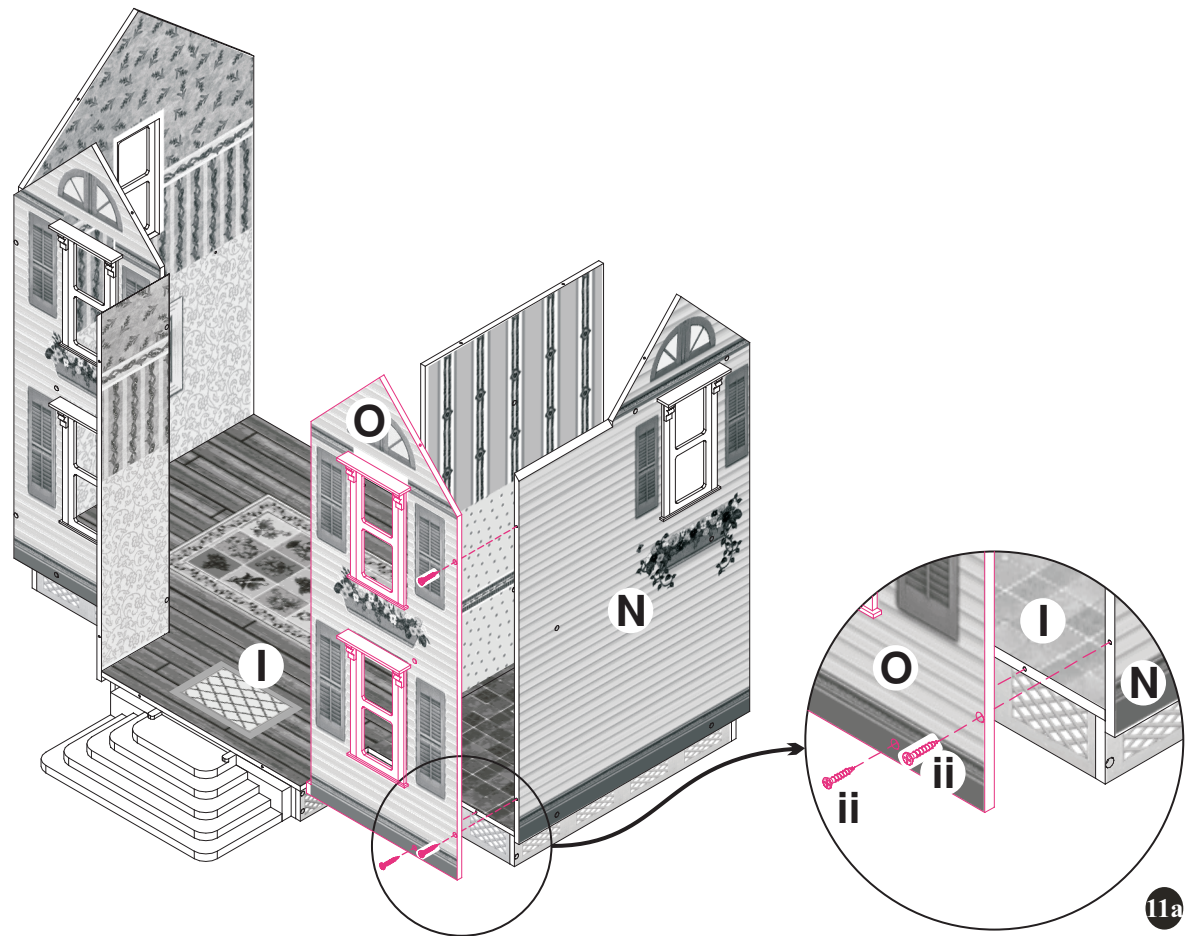

20

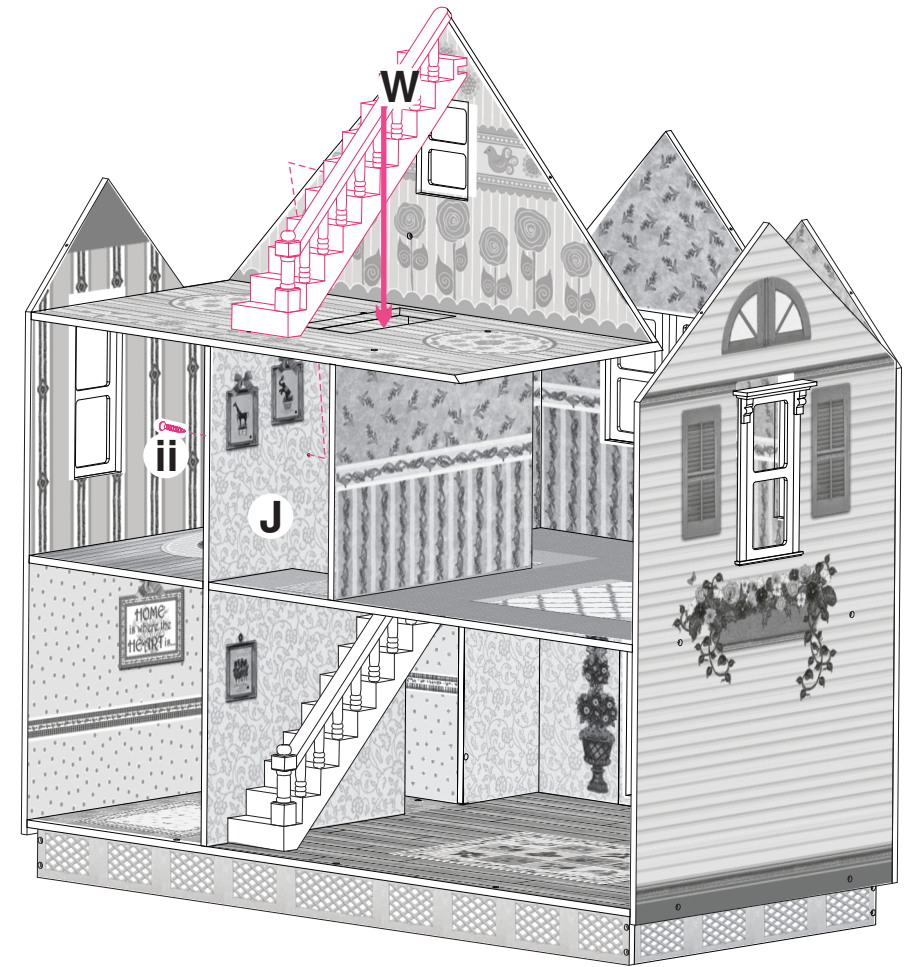

21

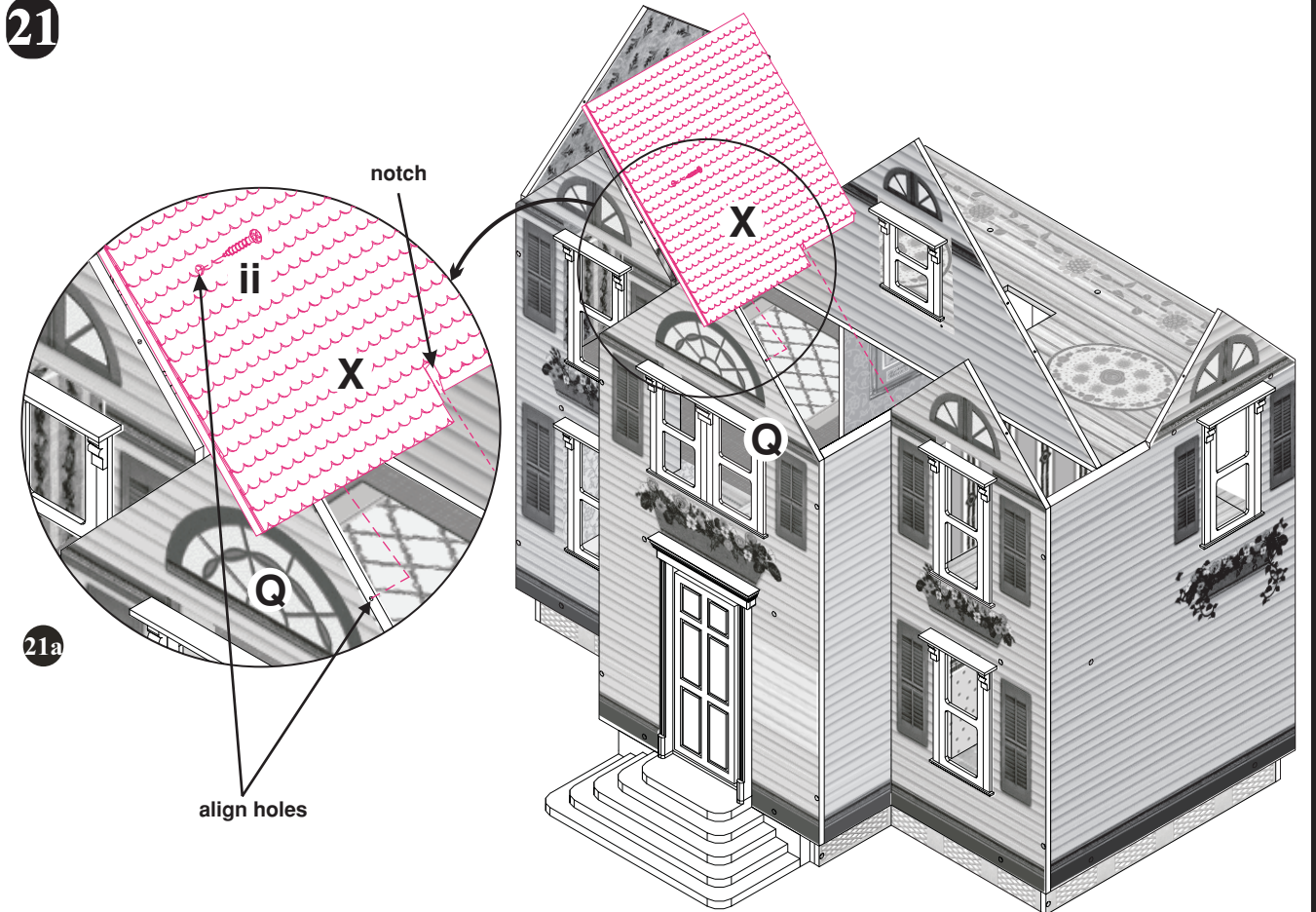



18

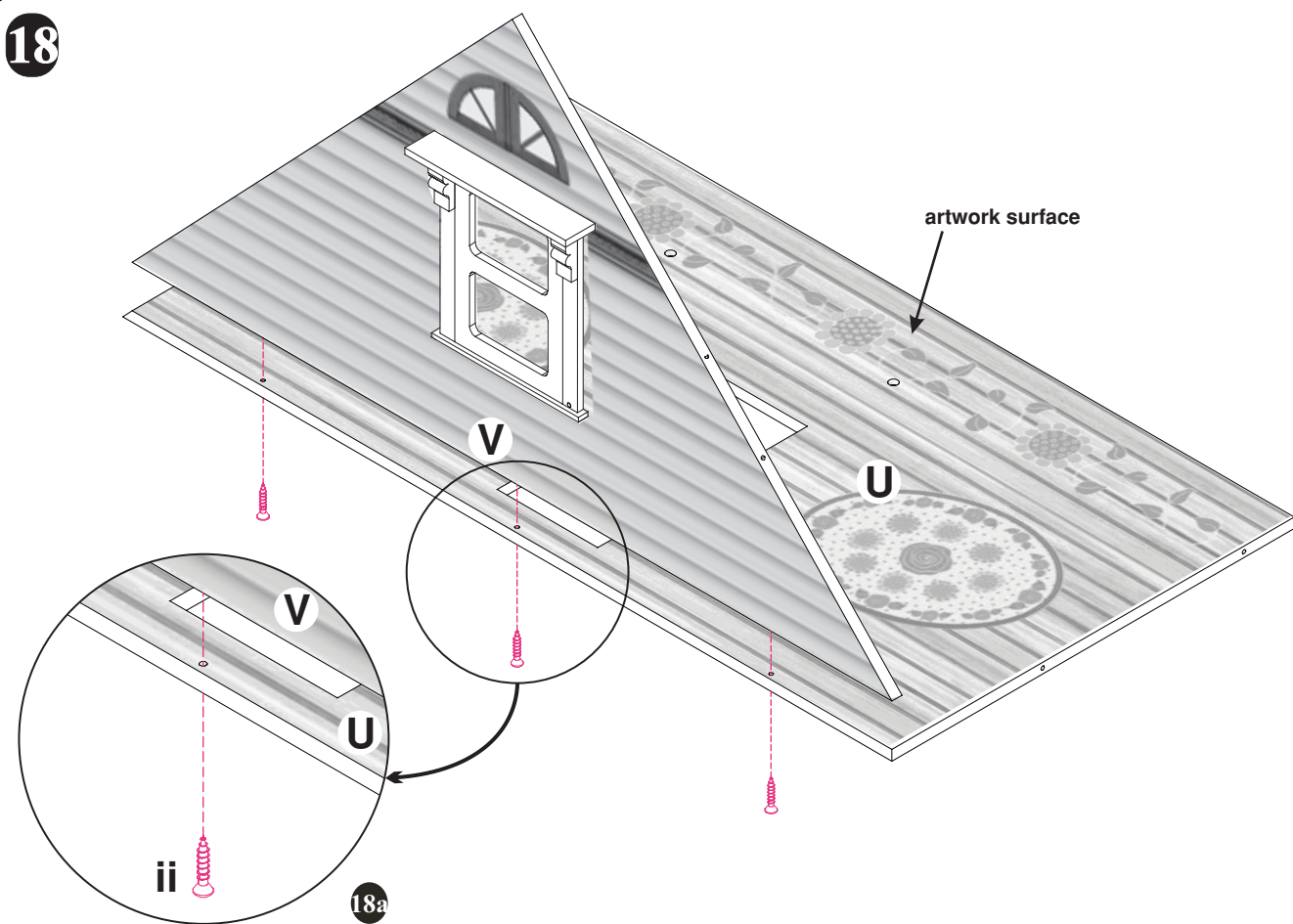

12

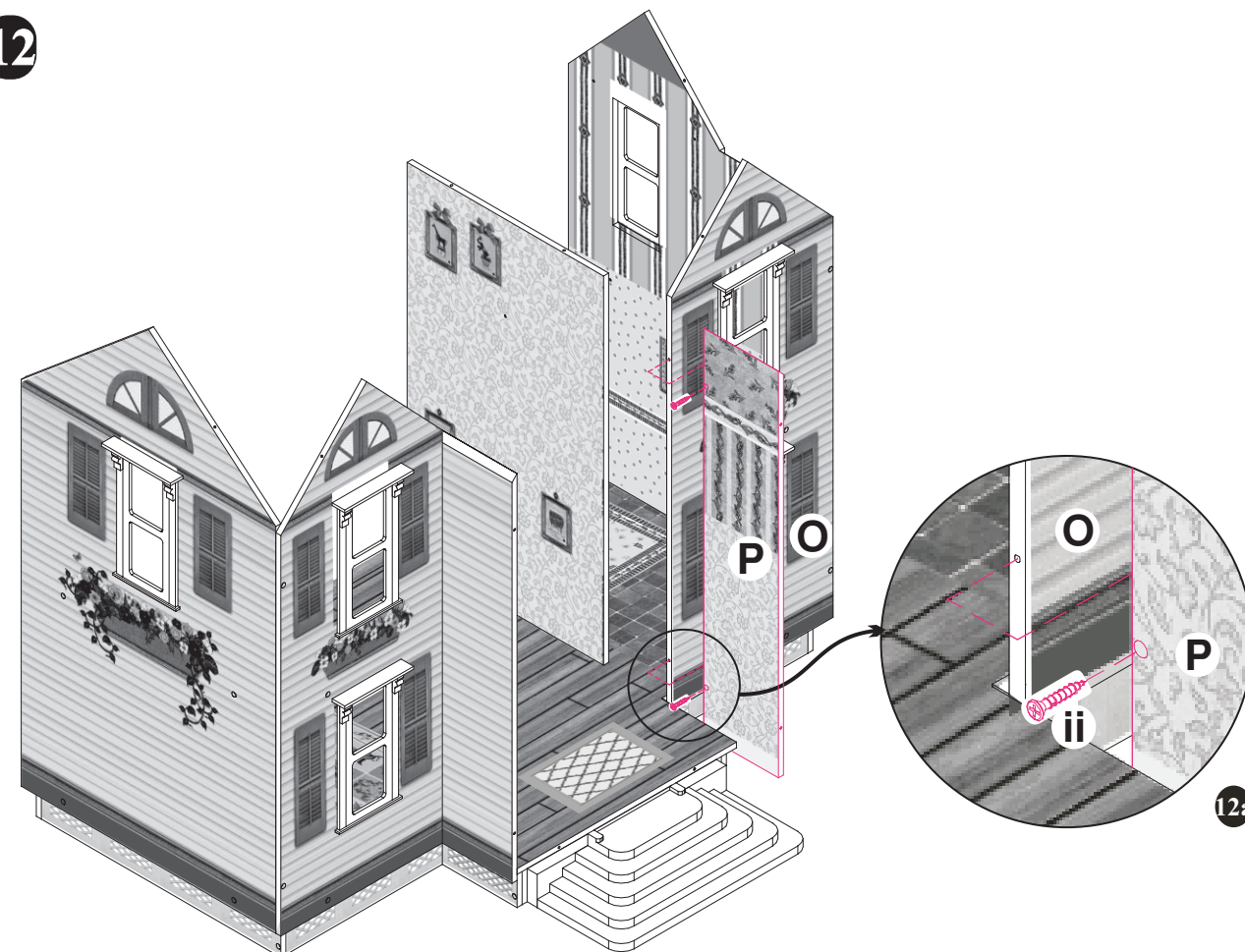

19

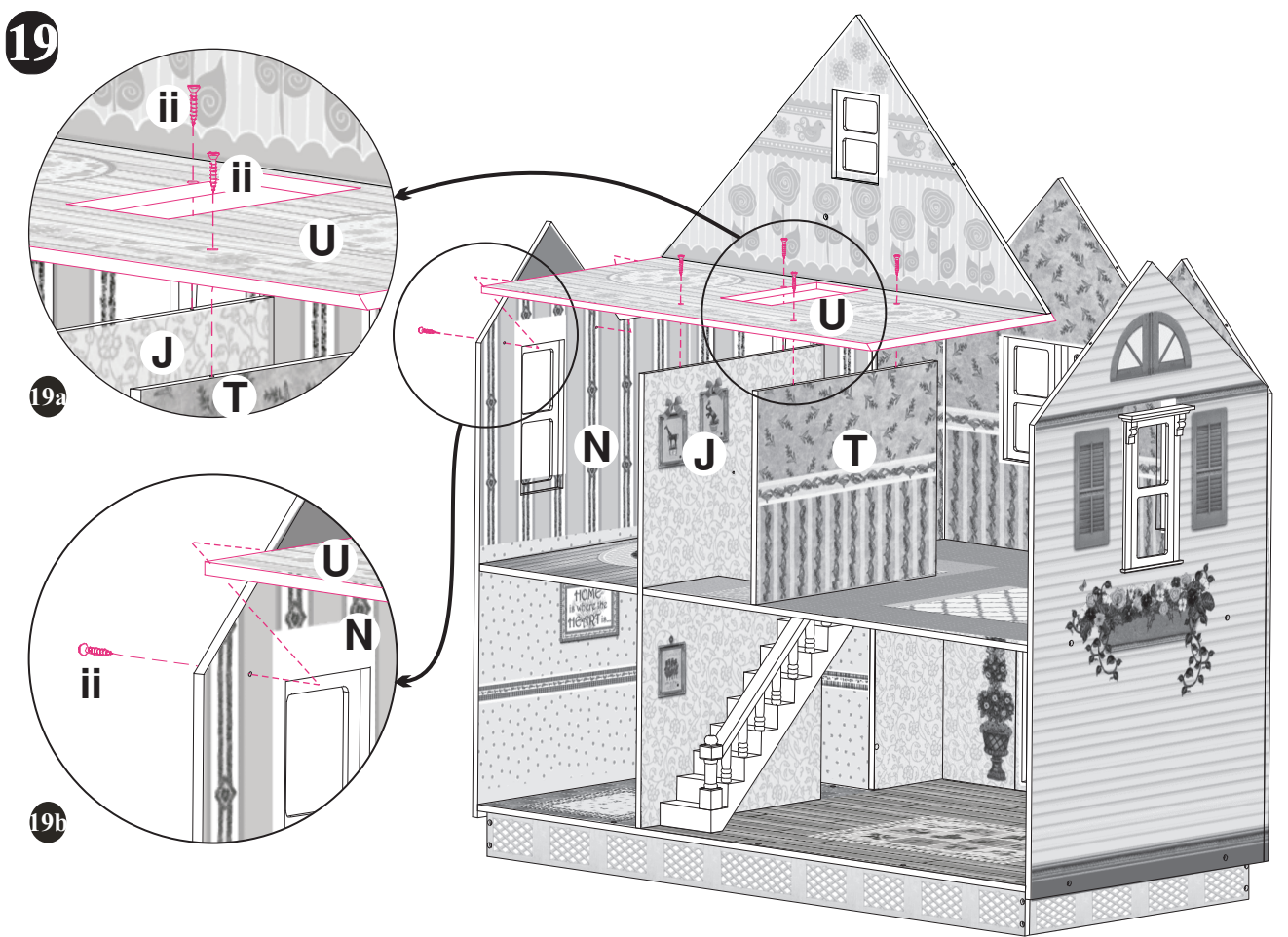

13

