

Important Information:

Before you begin assembly, please read these directions. After product is assembled make sure all bolts and screws are securely tightened. Store this instruction manual in the envelope attached to the mattress base for future reference.

If a part is missing or broken or if you have any questions please call us right away for customer service. Your complete satisfaction with this product is important to us. **Call 1-800-222-9243**

Thank you for purchasing this Today's Tot product. At BabyAge.com, our goal is to provide every customer with an exceptional online shopping experience. We take our customers' concerns seriously, and encourage open communication before, during, and after a purchase is made.

We strive to create a Today's Tot product that will be of lasting value to both you and your child. This product was constructed with high quality materials and is held to the highest safety standards.

Understanding that occasionally circumstances may result in a less-than-perfect product, we will make every possible effort to correct the situation.

If you have any type of question or comment regarding your Today's Tot product, I would encourage you to contact us via our web site contact form (<http://www.babyage.com/customersupport.aspx>) or our Toll-Free Customer Service number. 1-800-222-9243

Your complete satisfaction is of the utmost importance to us, and we thank you for the privilege of helping you care for your child.

Best,



Jack Kiefer (President & CEO)

today's•tot®

360 Stewart Road
Wilkes-Barre, PA 18706
www.todaysbaby.com
1-800-222-9243

Product Packaging Information

Model #: _____

Color: _____

Shipment Ref. #: _____

Date: _____

MADE IN CHINA

today's•tot®

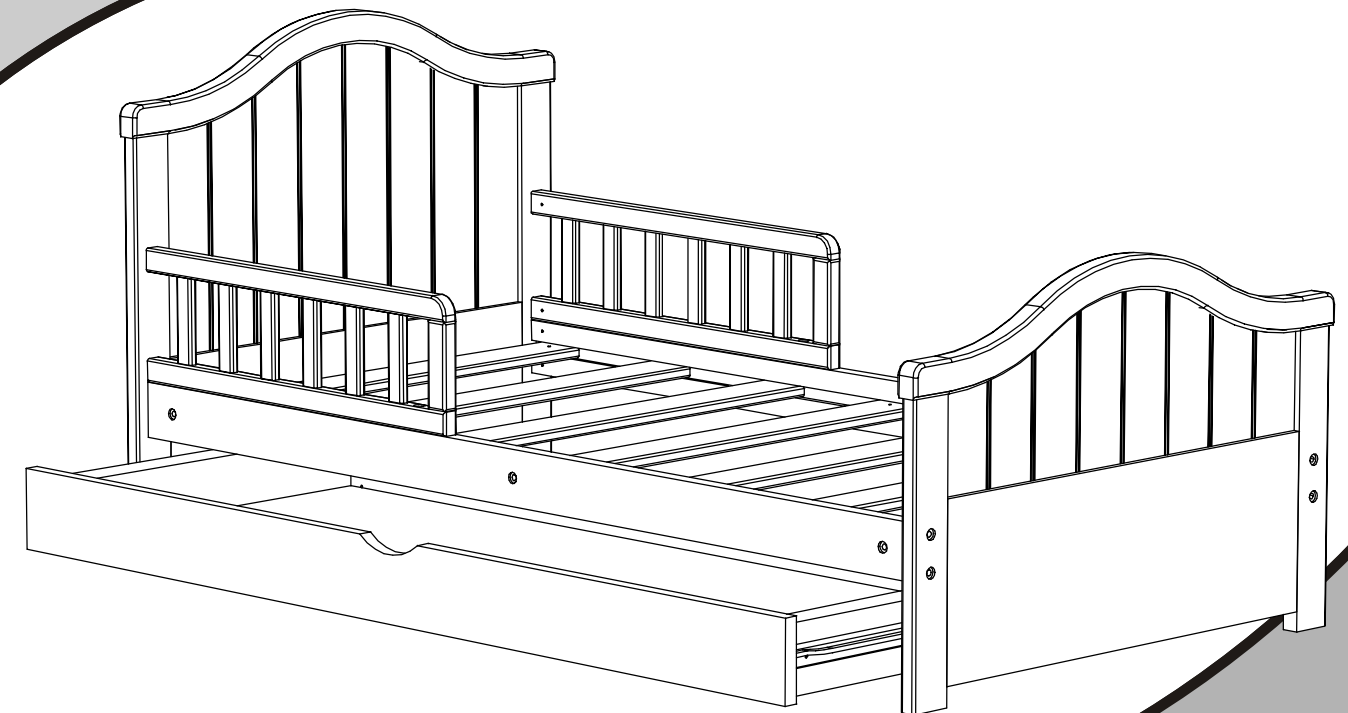

AUSTIN TODDLER BED WITH DRAWER

Important Information:

Before you begin assembly, please read these directions. See next page for important Warning statements on this product. After product is assembled make sure all bolts and screws are securely tightened. Store this instruction manual in the envelope attached to the mattress base for future reference.

! WARNING !

FAILURE TO FOLLOW THESE WARNINGS AND ASSEMBLY INSTRUCTIONS COULD RESULT IN SERIOUS INJURY OR DEATH!

- READ INSTRUCTIONS BEFORE assembling bed. KEEP INSTRUCTIONS FOR FUTURE USE. Do not use this bed if the instructions can not be strictly followed. DO NOT place bed near windows where cords from blinds or drapes may strangle a child.
- CAUTION: The mattress intended for use on this bed shall be a full size crib mattress having minimum dimensions of 51-5/8 inches (1310 mm) in length and 27-1/4 inches (690 mm) in width and 4 inches (100 mm) in thickness..
- The minimum age shall not be less than 15 months and the maximum weight shall not be greater than 50lbs (22.7kg).
- Do not use a water mattress with this bed.
- Do not place items with a string, cord, or ribbon around a child's neck, such as hood strings or pacifier cords.
- Do not suspend strings over a toddler bed for any reason.
- Make sure to place this bed in your child's room keeping in mind hazards such as windows, walls and other pieces of furniture. Windows are dangerous if the child can use the bed to climb out of the window. For other pieces of furniture and walls, a min of 12 inches is recommended between the bed and the furniture or wall, to reduce the risk a child may slide into the smaller spaces and suffocate.

Maintenance, Cleaning and Storage

- Regularly check to make sure that the bolts are all fastened tightly. Due to regular wear and tear, they can come loose.
- To clean bed, use only mild household soap and warm water. Do not use bleach or detergent. Do not use abrasive cleaners which can scratch the finish of the bed. Use clean soft cloths to wash, rinse and dry. With proper care, the quality finish will last a long time. Wood surfaces may be treated with light application of a good grade of non-toxic furniture polish.
- When this toddler bed is no longer needed, follow the assembly steps in reverse to dismantle it and store it in a safe and dry place so that it will not pose a danger to any child.
- Store all hardware and these instructions inside the envelope attached to the mattress base to keep it safe and handy for future use.

11

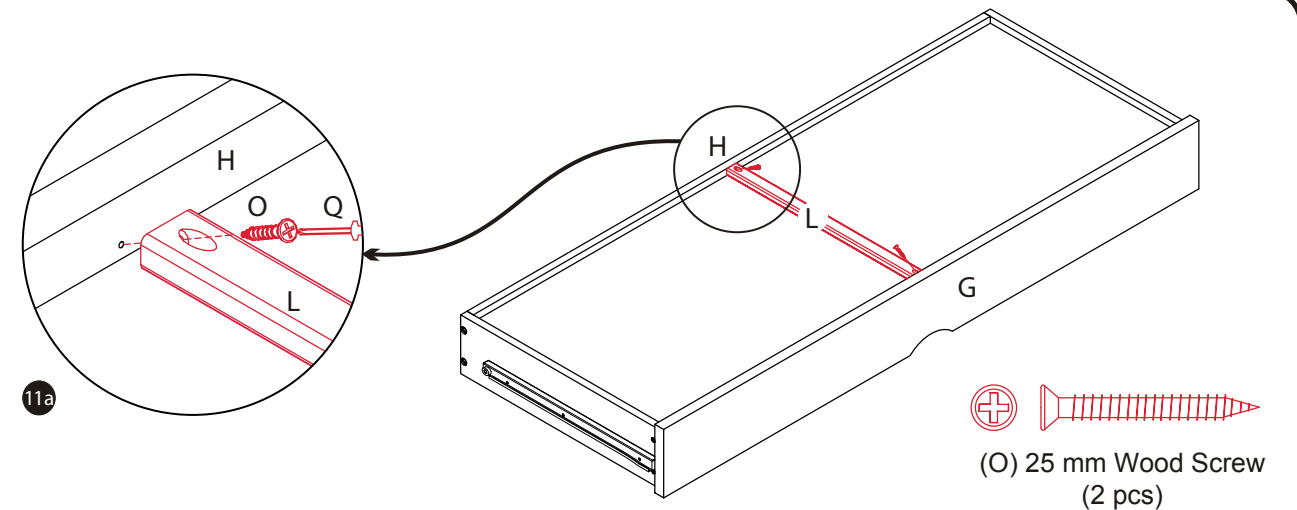

Flip over drawer unit and attach the Drawer Support (L) using two 25 mm Wood Screws (O) and Screwdriver (Q) to both the front and back drawer panel.

12

Tip assembled drawer on an angle so you can insert the wheel on the side metal track into the gap on the metal track on the head and foot board. Once inserted on both sides, lower the drawer and slide in.

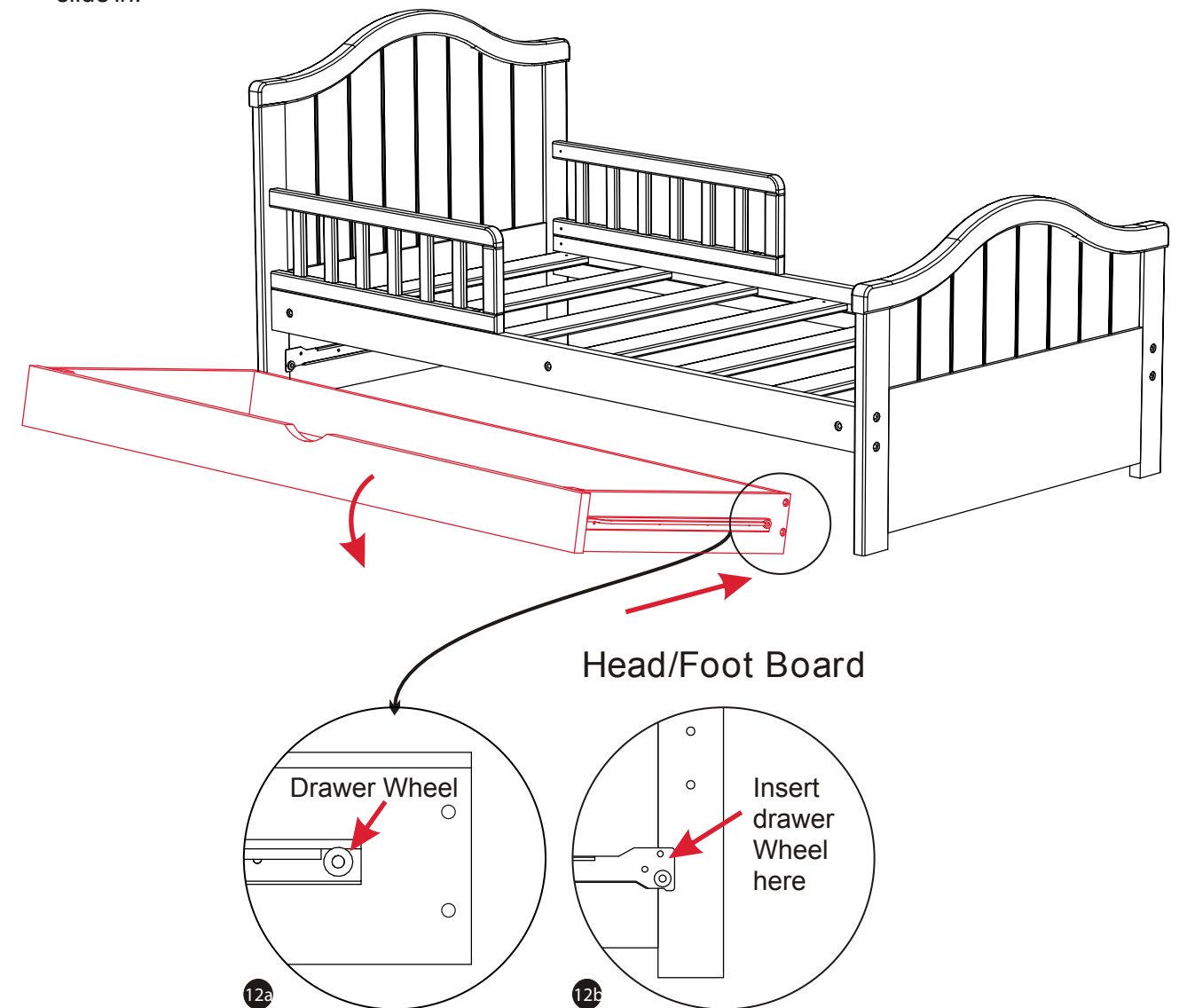

REMINDER: Tighten ALL bolts at this time to ensure product is assembled correctly.

DRAWER ASSEMBLY

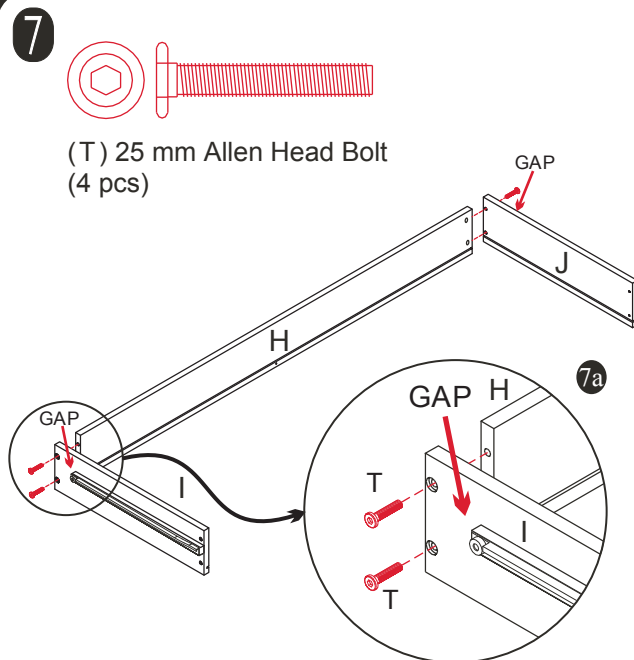

(T) 25 mm Allen Head Bolt
(4 pcs)

Line up the Drawer Back Panel (H) with the Drawer Left Panel (I) and attach using two 25mm Bolts (T). Ensure that the metal drawer track is facing outwards and the gap is at the back of the panel as shown in the diagram. Repeat for other side using the Drawer Right Panel (J).

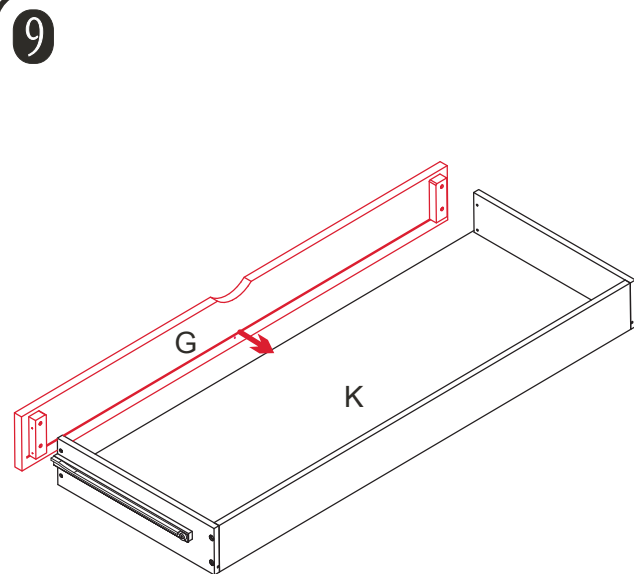

Line up Drawer Front Panel (G) so drawer bottom panel fits into groove.

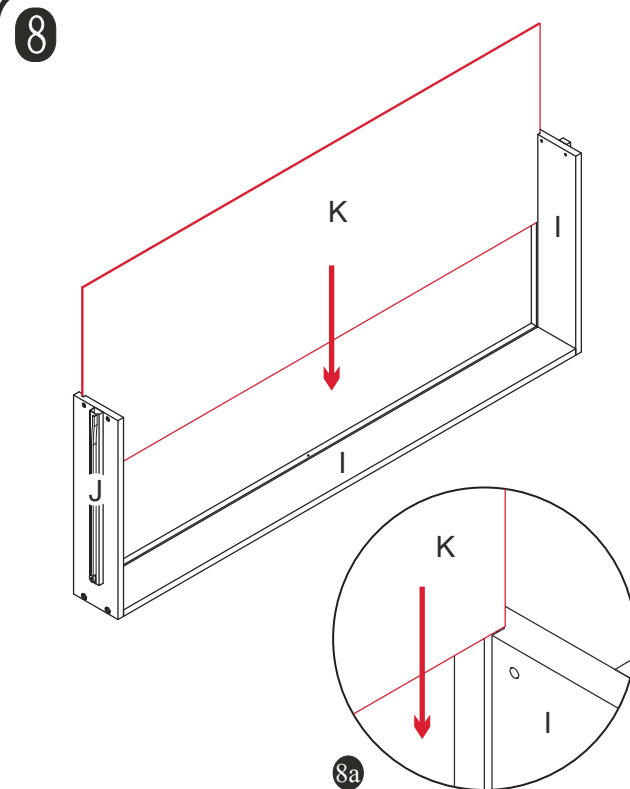

Place drawer on back panel and slide in the Drawer Bottom Panel (K) into the groove.

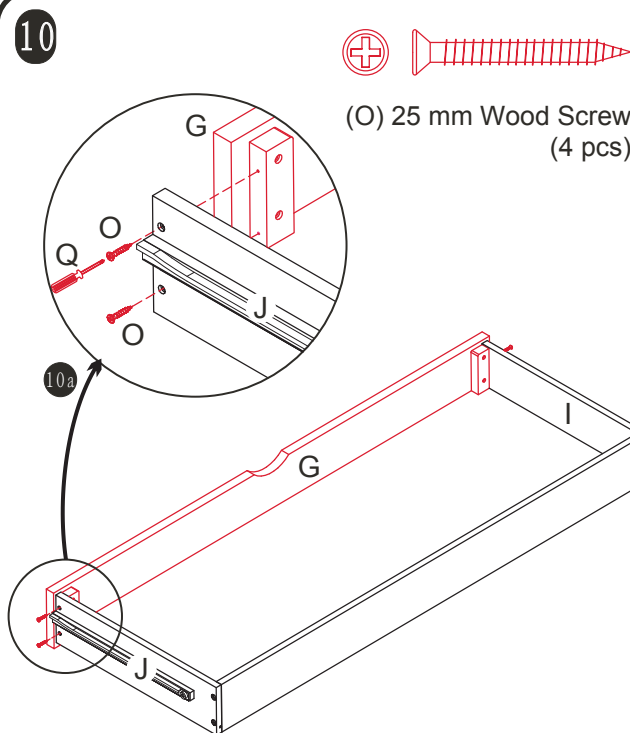

Screw two 25 mm Wood Screws (O) with the Screwdriver (Q) through the drawer side panel and into the corner block attached to the drawer front panel. Repeat for other side.

PART LIST

Toddler Bed Components

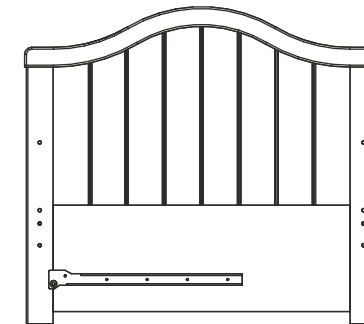

(A) Headboard
(1 pc)

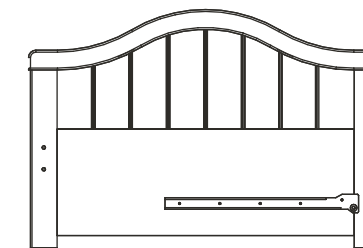

(B) Footboard
(1 pc)

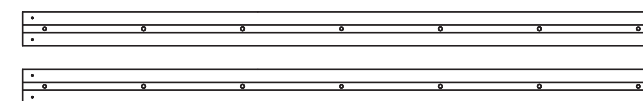

(C) Mattress Support Rails
(2 pcs)



(D) Mattress Mullions
(3 pcs)



(E) Mattress Slats
(6 pcs)

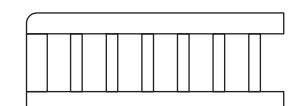

(F) Safety Rails
(2 pcs)

Drawer Components



(G) Drawer Front Panel
(1 pc)



(H) Drawer Back Panel
(1 pc)

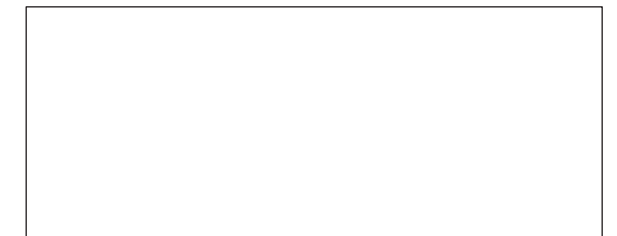

(K) Drawer Bottom Panel
(1 pc)



(I) Drawer Left Panel
(1 pc)



(J) Drawer Right Panel
(1 pc)

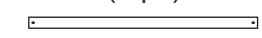

(L) Drawer Support
(1 pc)

Hardware Assembly Set

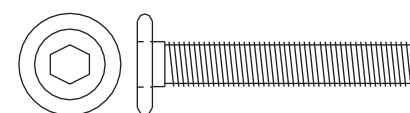

(M) 40 mm Allen Head Bolt
(8 pcs)



(N) Barrel Nut
(6 pcs)

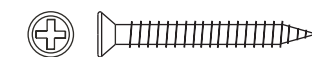

(O) 25 mm Wood Screw
(6 pcs)

(P) Allen Key
(1 pc)

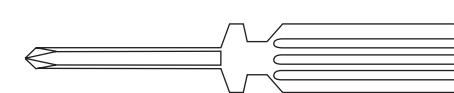

(Q) Screwdriver
(1 pc)

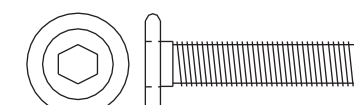

(R) 32mm Allen Head Bolt
(12 pcs)

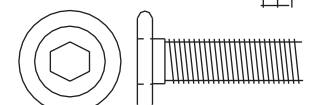

(T) 25mm Allen Head Bolt
(4 pcs)

TODDLER BED ASSEMBLY

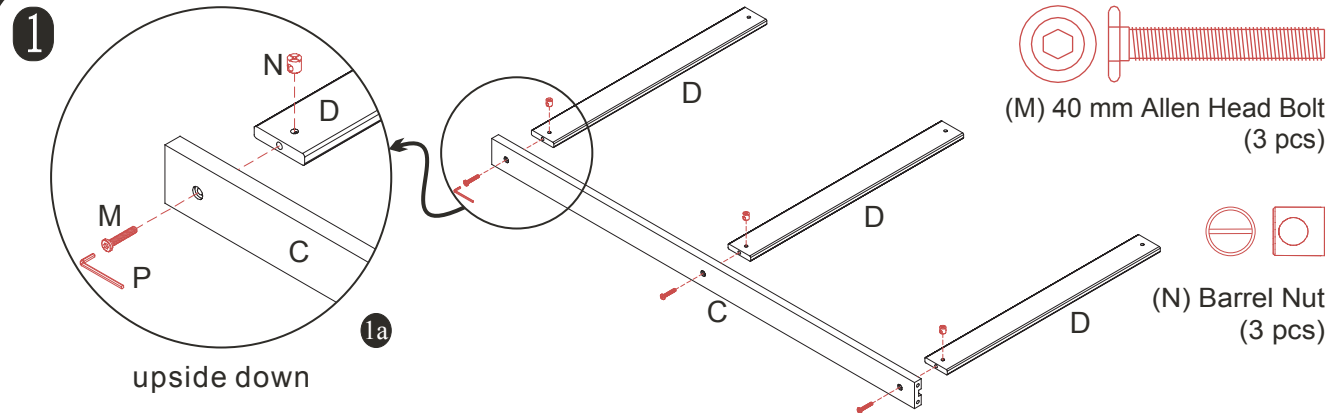

Place three Mattress Mullions (D) upside down with the holes for Barrel Nuts facing up, then bolt in using three 40mm Bolts (M) and Barrel Nuts (N) to one of the Mattress Support Rails (C). To tighten all the bolts on this product safely, an Allen Key (P) is provided. After complete assembly it is strongly recommended that you check all bolts with this key to ensure they are securely tightened before use.

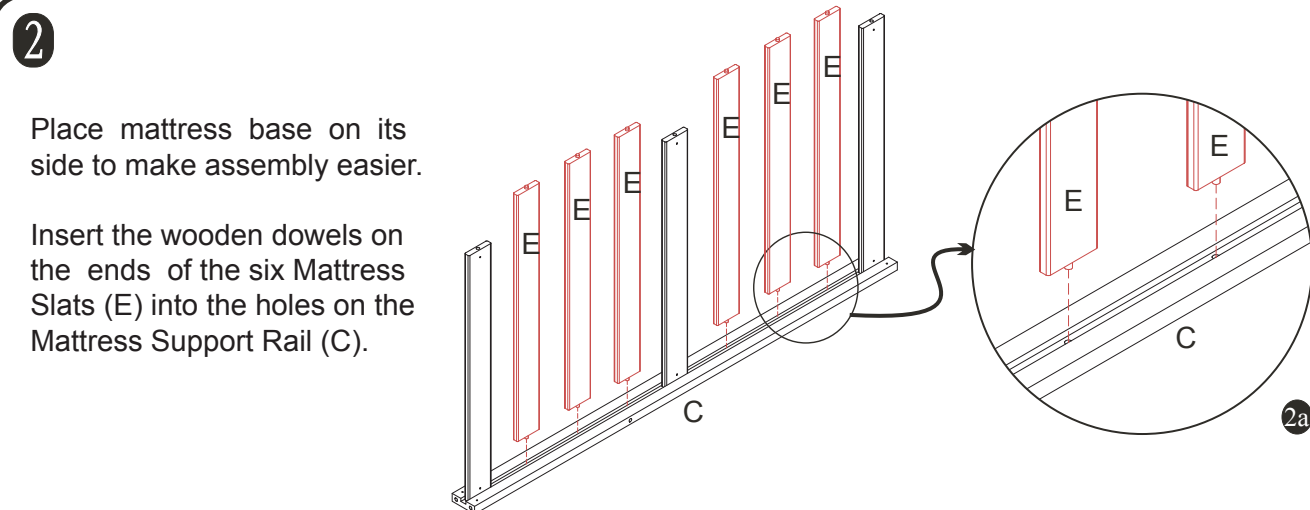

Place mattress base on its side to make assembly easier.

Insert the wooden dowels on the ends of the six Mattress Slats (E) into the holes on the Mattress Support Rail (C).

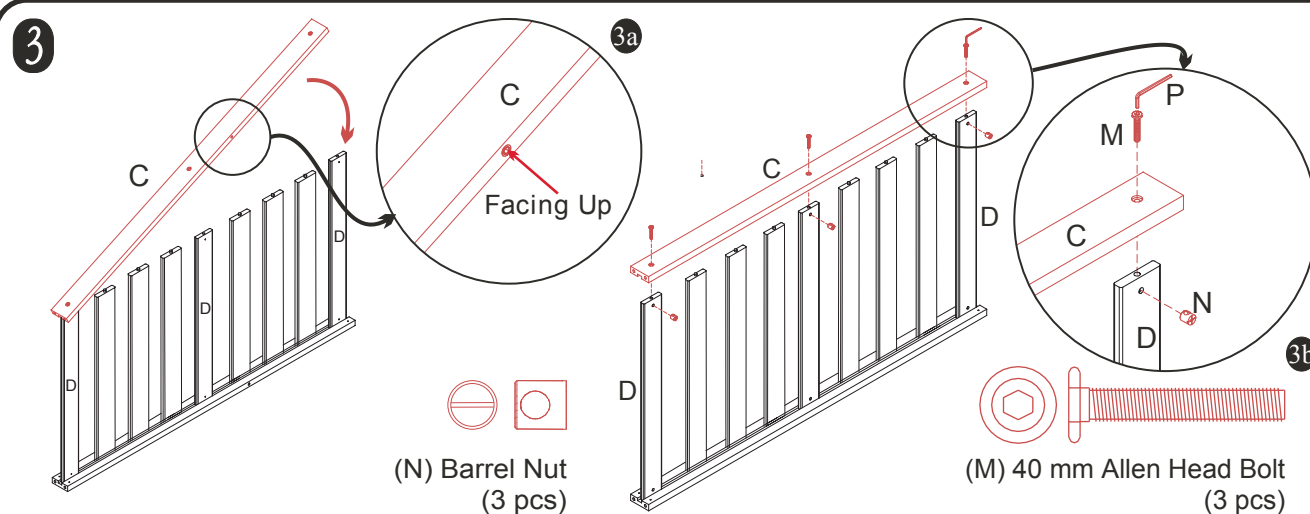

Line up all Mullions (D & E) with the holes on the Mattress Support Rail (C) and starting at one end bolt in the three Mattress Mullions (D) with the 40 mm Bolts (M) and Barrel Nuts (N). Before tightening the bolts, make sure the holes on the support rail are facing up like the holes on the other rail and also that all the Mullion Slats are inserted properly in the holes.

Ensure that all bolts are tightened securely at this time.

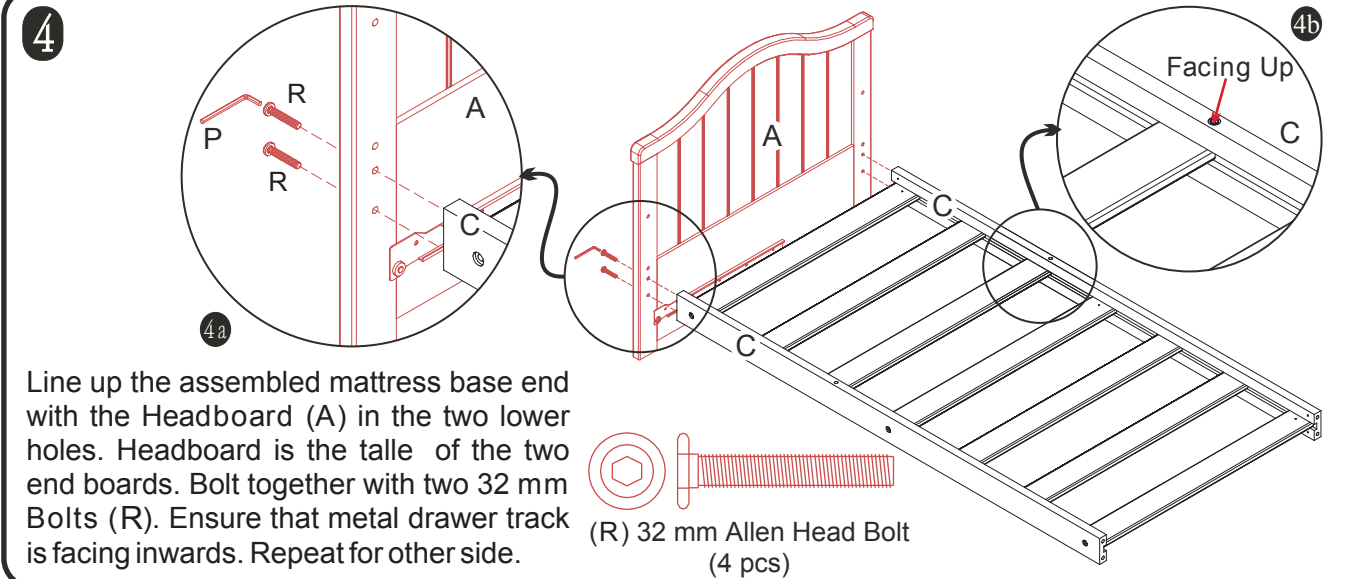

Line up the assembled mattress base end with the Headboard (A) in the two lower holes. Headboard is the taller of the two end boards. Bolt together with two 32 mm Bolts (R). Ensure that metal drawer track is facing inwards. Repeat for other side.

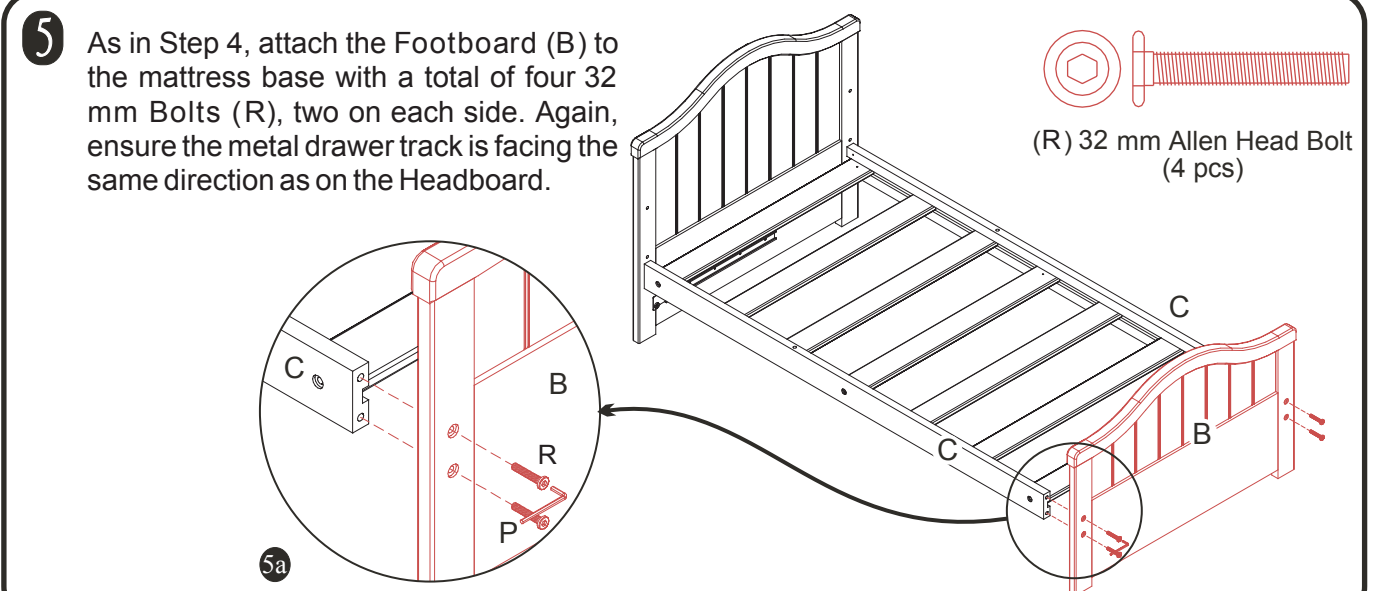

As in Step 4, attach the Footboard (B) to the mattress base with a total of four 32 mm Bolts (R), two on each side. Again, ensure the metal drawer track is facing the same direction as on the Headboard.

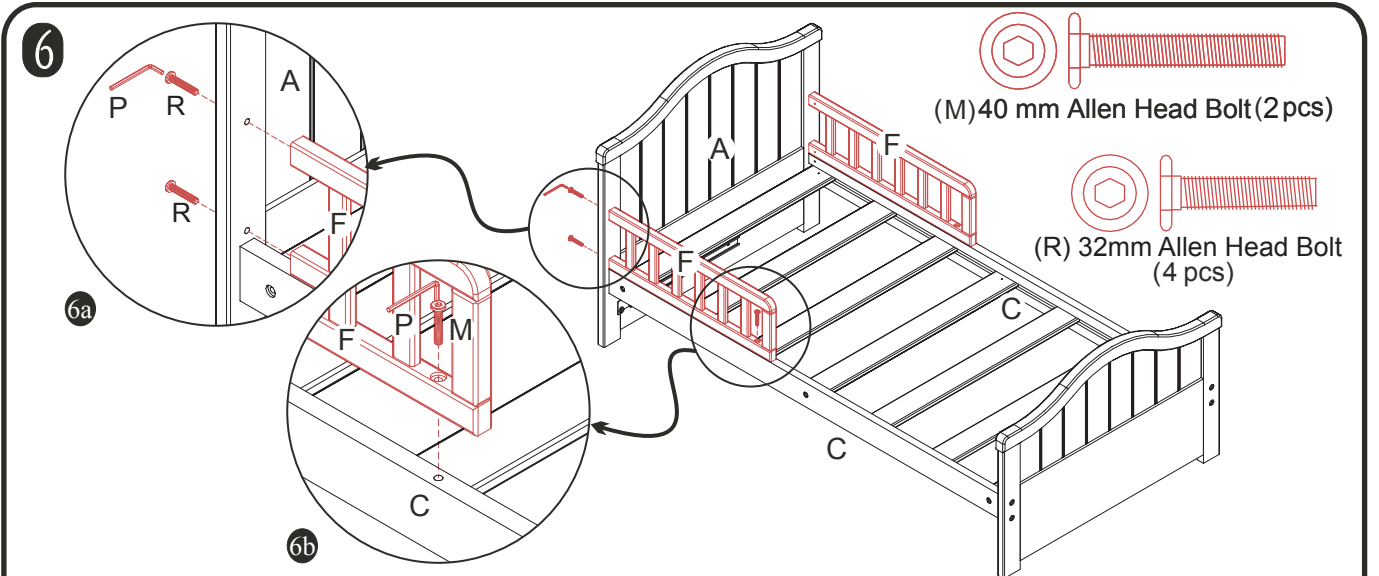

Place the Safety Rail (G) on top of the mattress base rail and push up against the Headboard (A). Insert two 32mm bolts (R) through headboard into ends of Safety Rail. To attach the Safety Rail to the mattress base rail use one 40 mm Bolt (M). Repeat for other side.

REMINDER: Tighten ALL bolts at this time to ensure product is assembled correctly.